

# Using Grubhub Campus Ohio State University



# Grubhub Campus Home Screen

Toggle between  
OSU Dining and Off-Campus  
Dining options

View available campus card balance

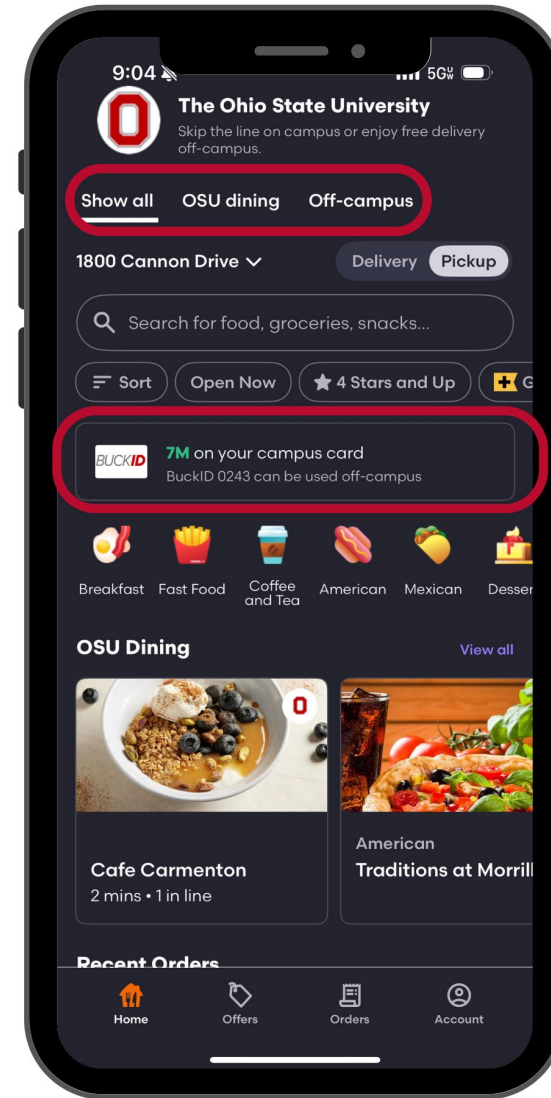

# Home Screen

View your delivery address  
Always verify your delivery address before  
placing an order

Sort by “Recommended” or  
“Fastest”

Toggle between  
Pickup or Delivery

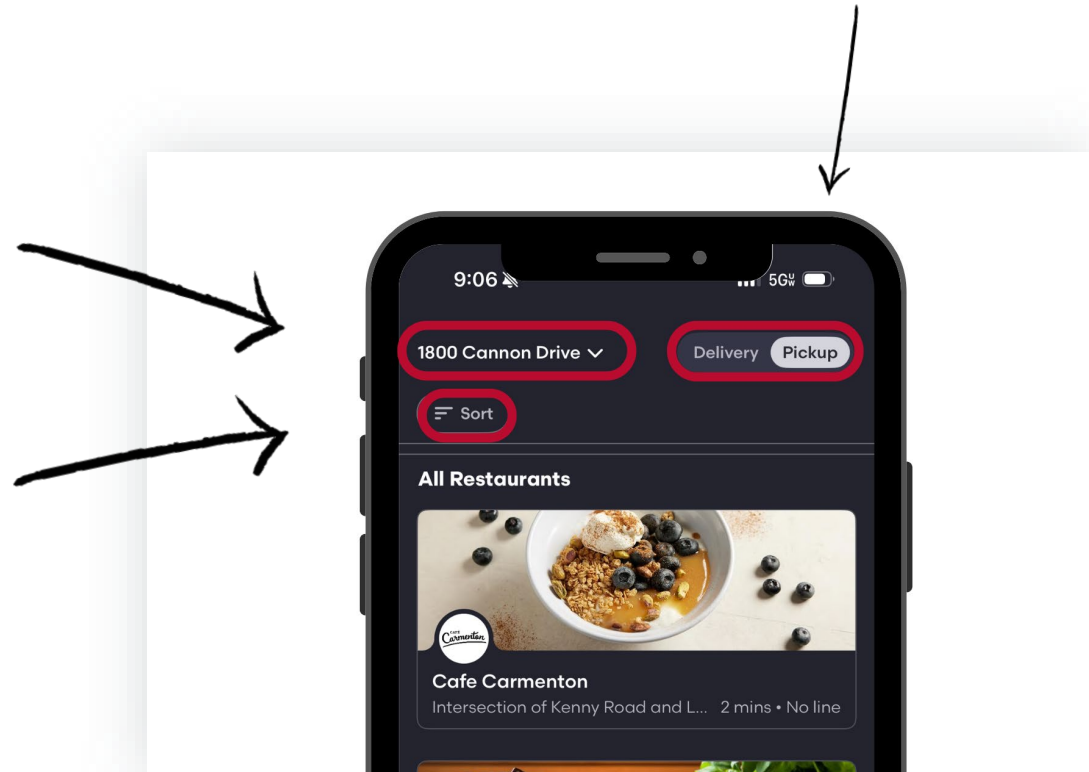

# Dining Locations

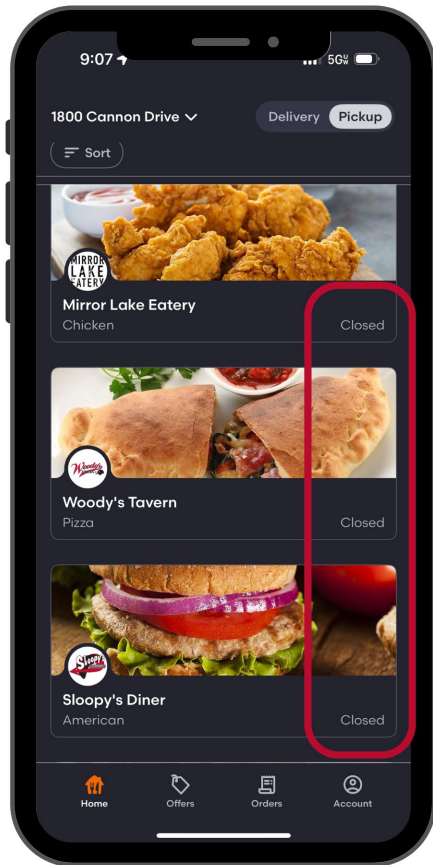

Shop Status (Open or Closed)

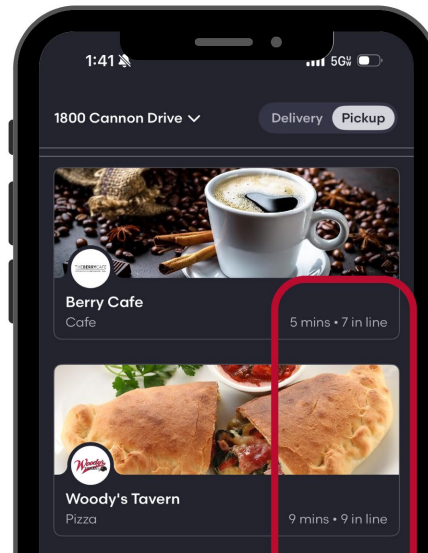

Estimated prep and pickup times

Number of people  
“in line” (in the order queue)



# Placing a Pickup Order



# Choose location

When placing an order,  
first select a location

Estimated Pickup Times

Item Categories

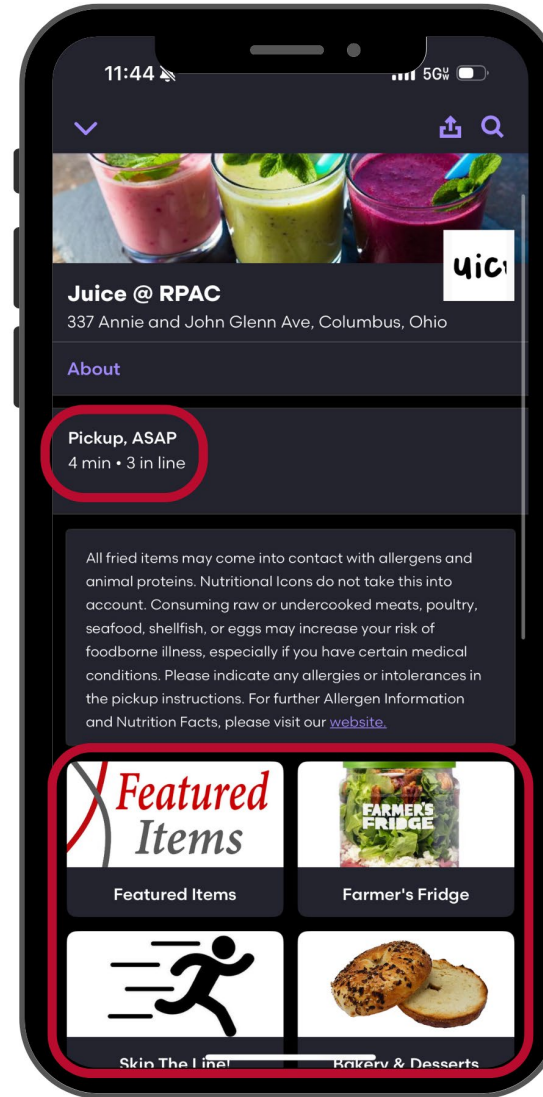

# Add items

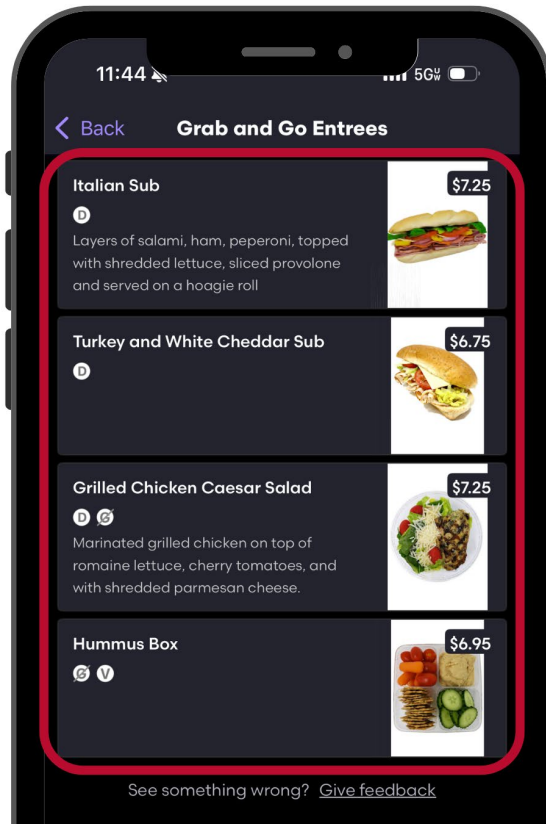

Select items  
and  
Add to bag

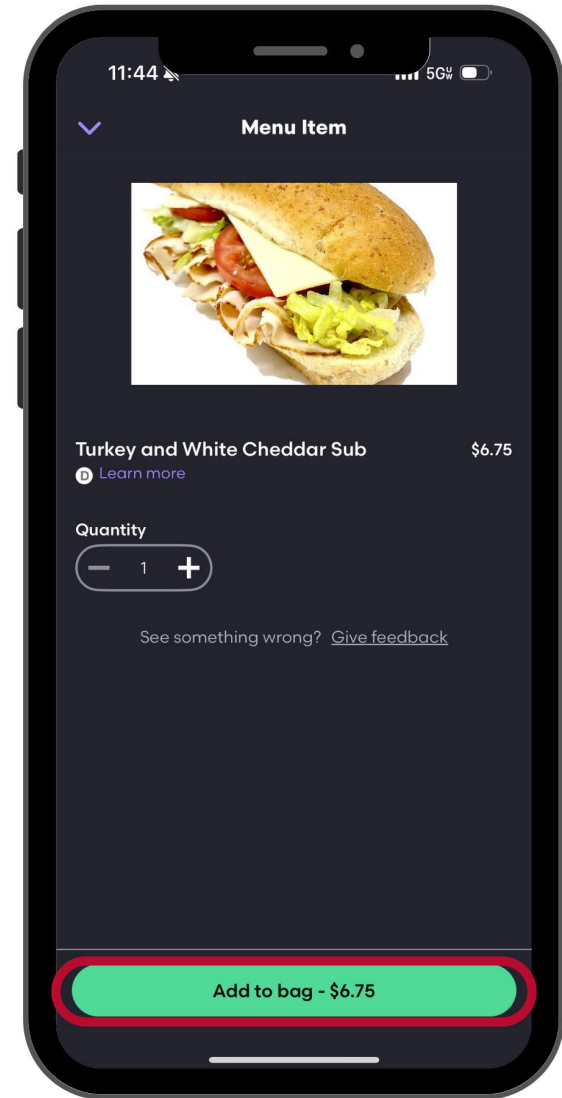

# Order instructions

Add notes for your order, including allergies, dietary restrictions, special requests, etc.

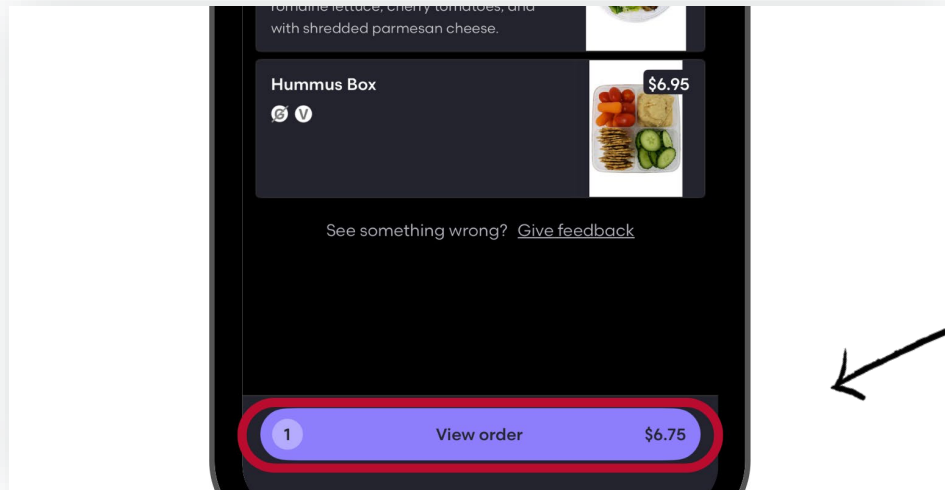

View your order  
and  
Continue to  
checkout

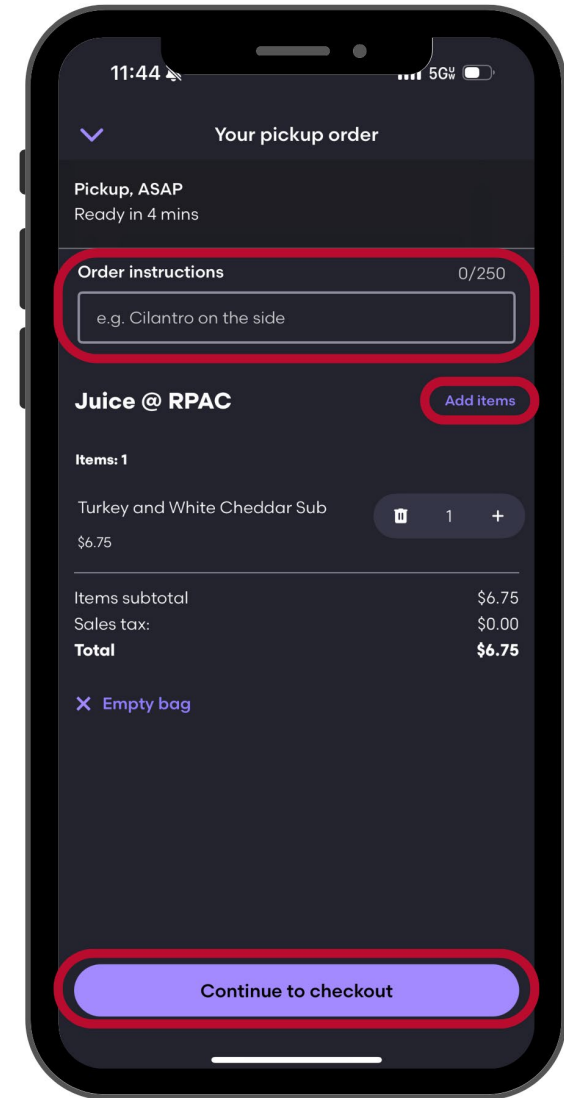



# Confirm

Confirm your contact information

Full breakdown of all order selections, modifications and prices

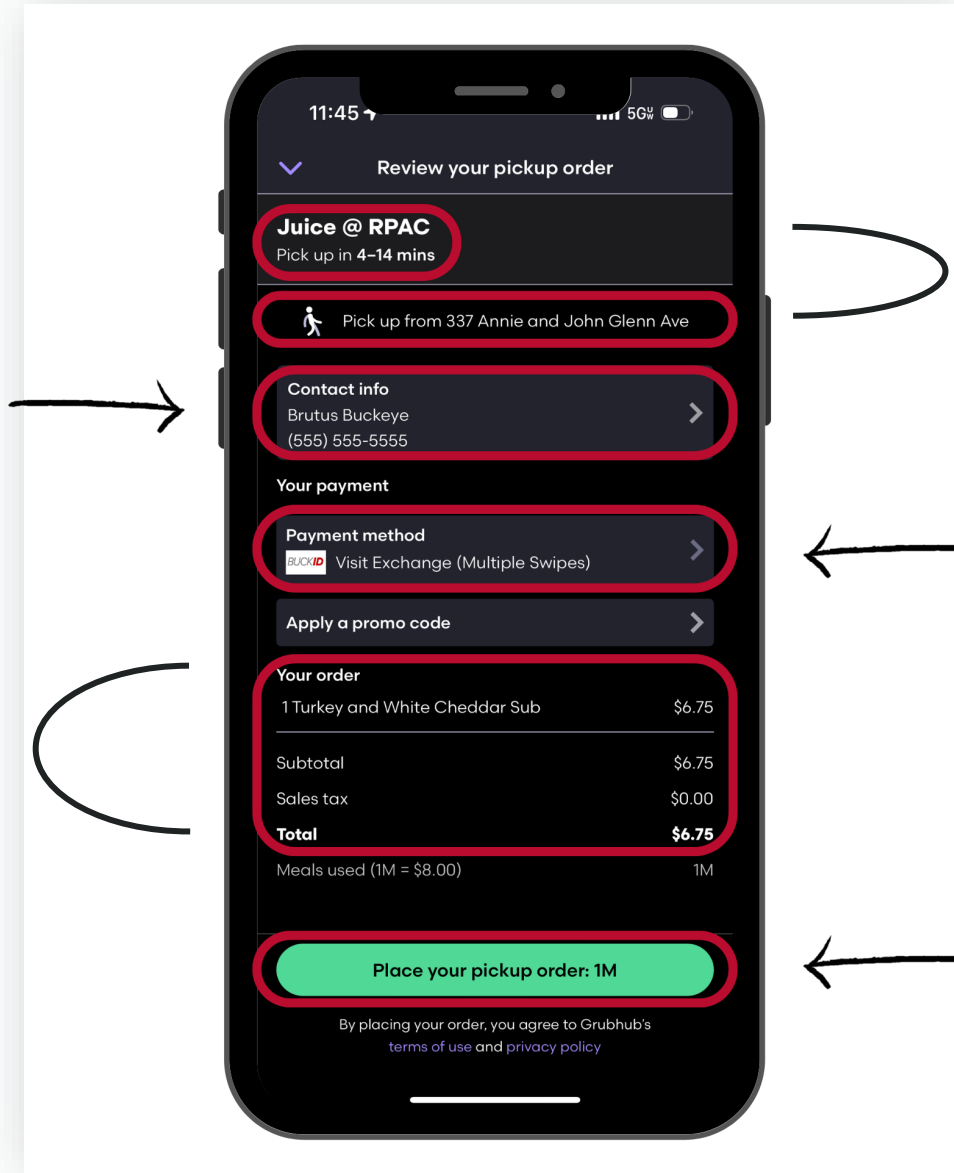

Location information and expected pickup time

Payment method

Always verify before placing an order

Place your order



# Track order

Track your order from start to finish

Monitor “Real-time Line Updates” to view your position in the queue

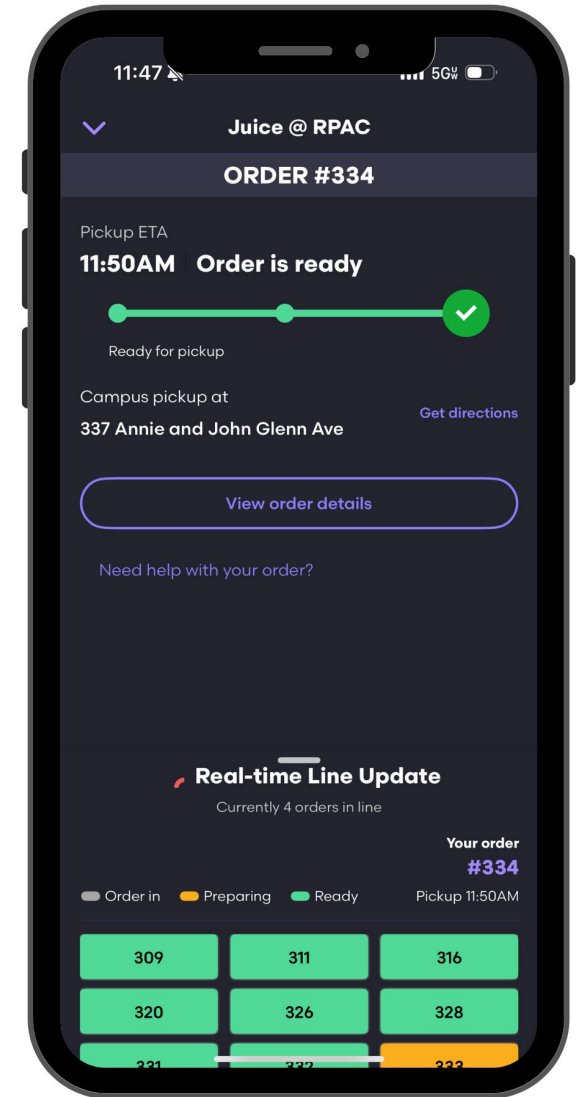
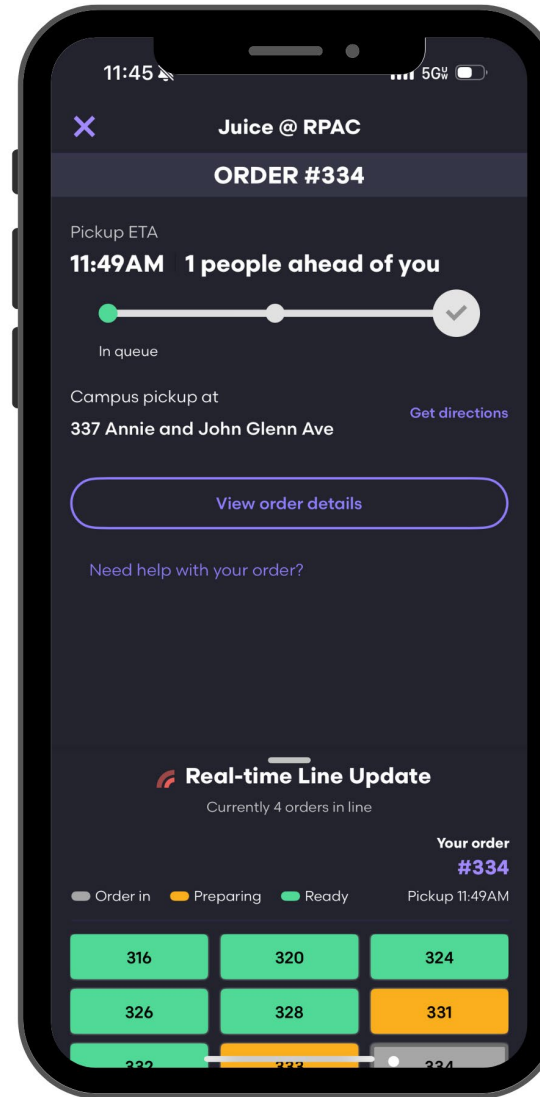

# Placing a Delivery Order



# Select Delivery

View available robot delivery locations

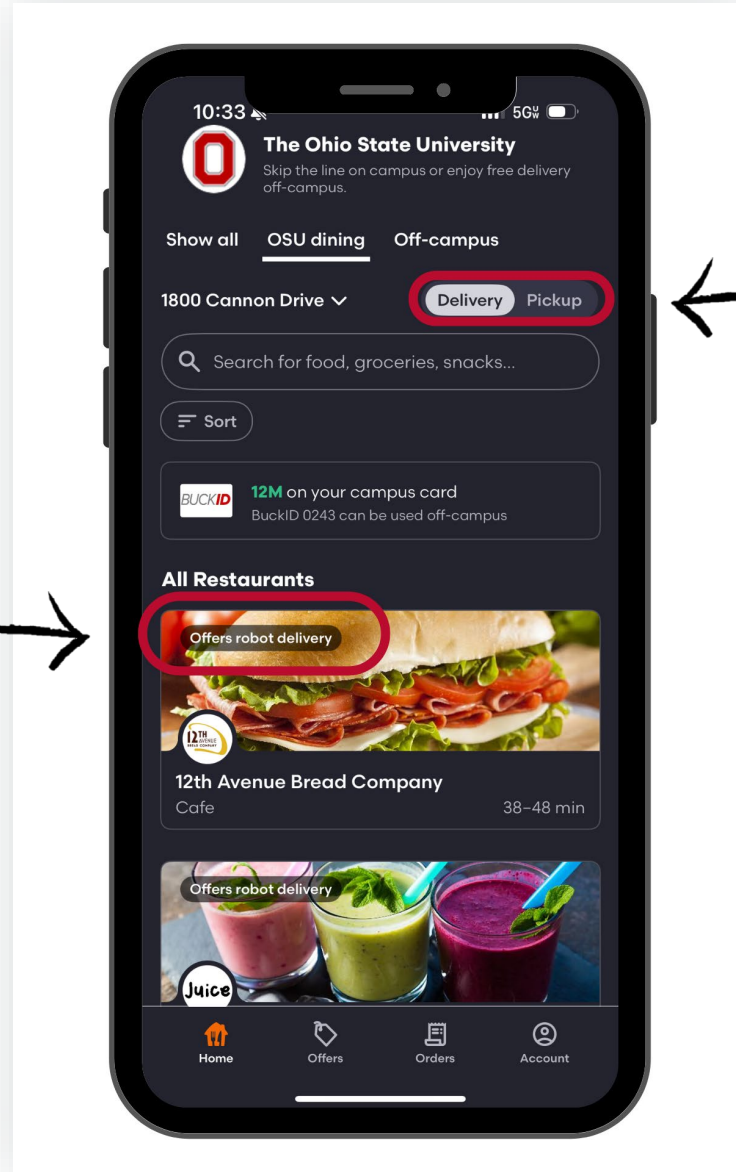

Toggle service type to delivery

# Ordering

Estimated delivery time

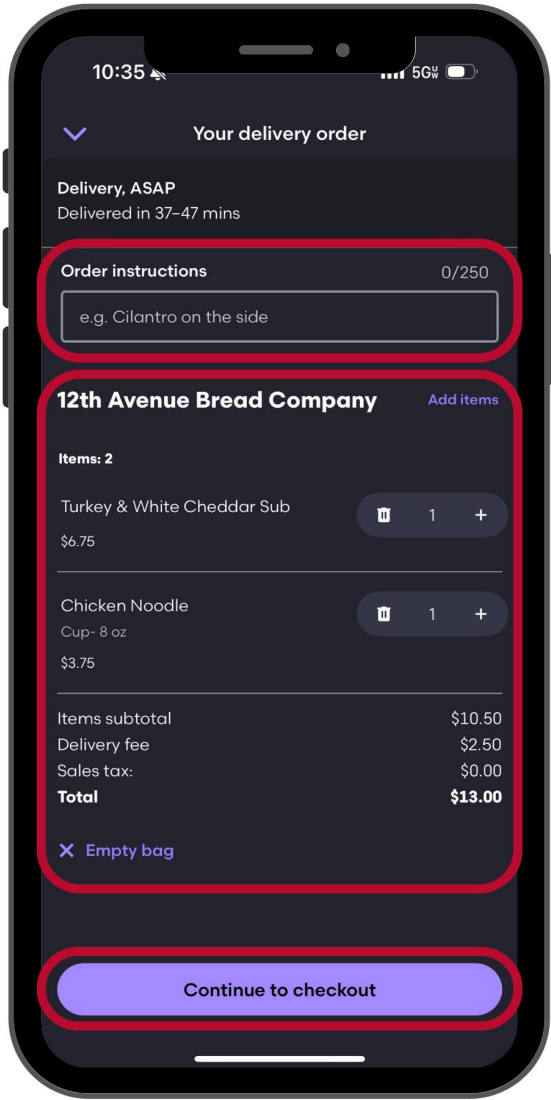
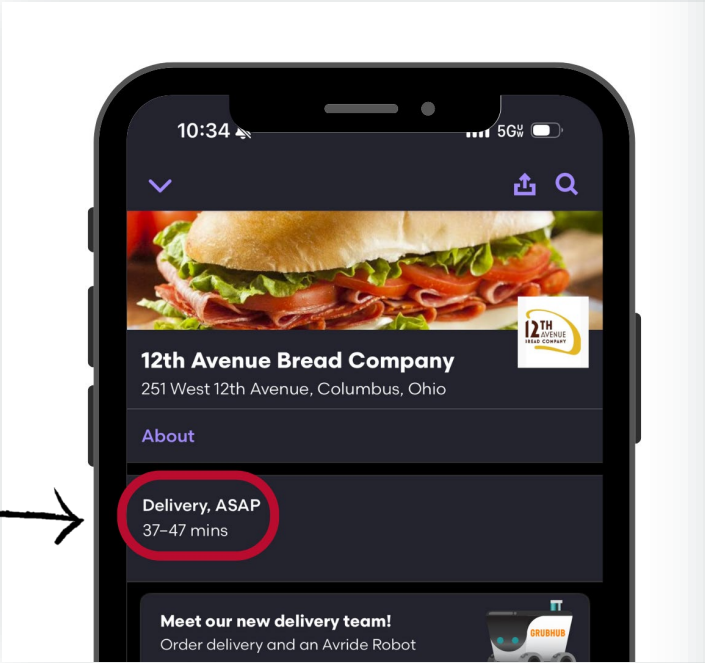

Add notes for your order, including allergies, dietary restrictions, special requests, etc.

Full breakdown of all order selections, modifications, and prices

Continue to checkout

# Check information

Location information  
and expected pickup  
time

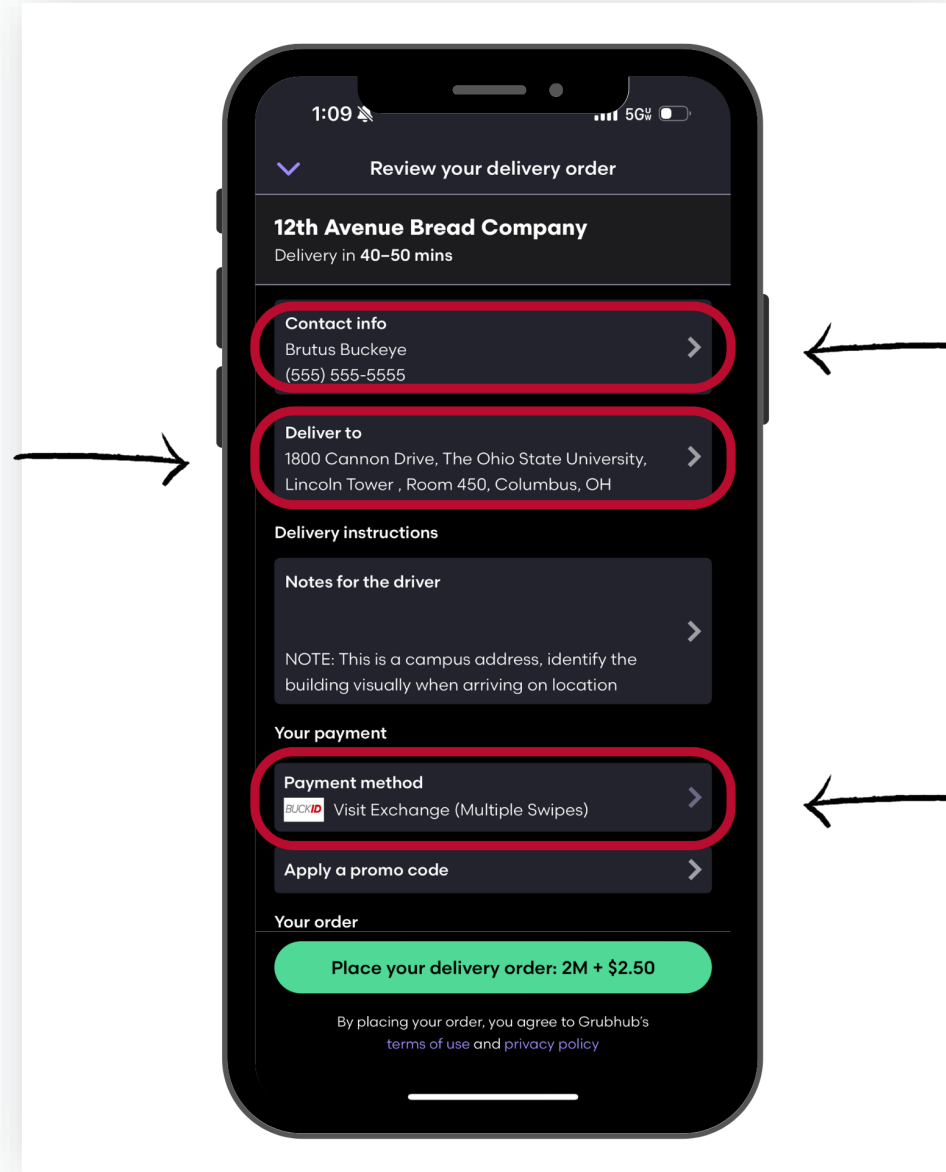

Confirm your contact  
information

Payment method  
\*Always verify you are  
using your desired  
payment method\*



THE OHIO STATE UNIVERSITY

# Place order

Delivery fee  
\*Tap to change  
method of payment\*

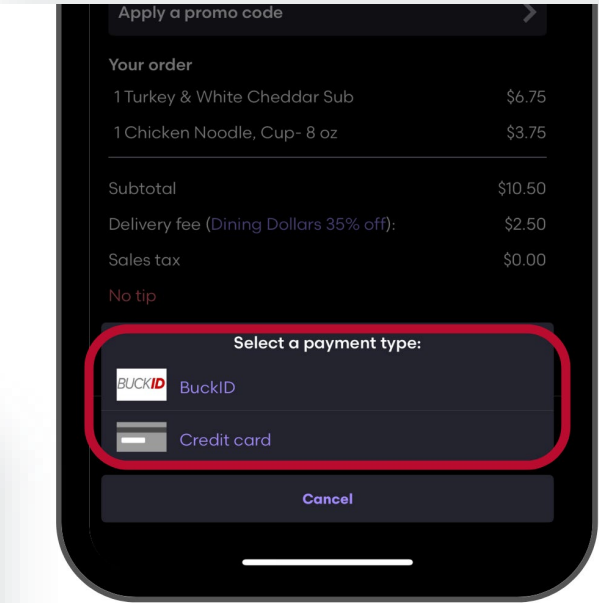
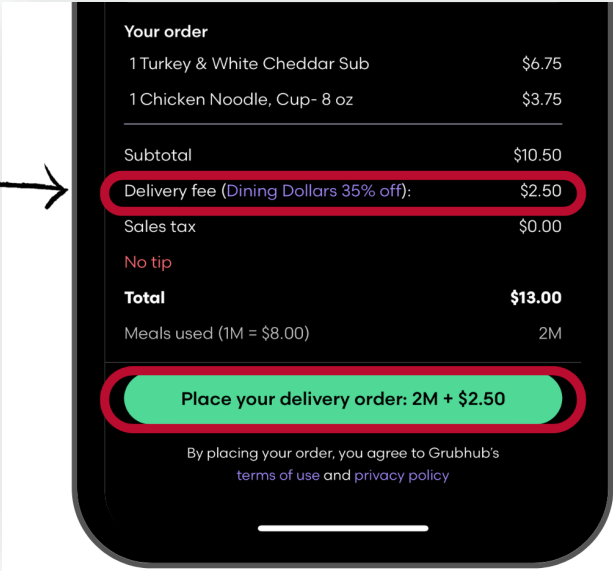

Select payment  
method for  
delivery fee

Place your delivery order



# Tracking Your Delivery Order





# Timeframe

Estimated delivery time

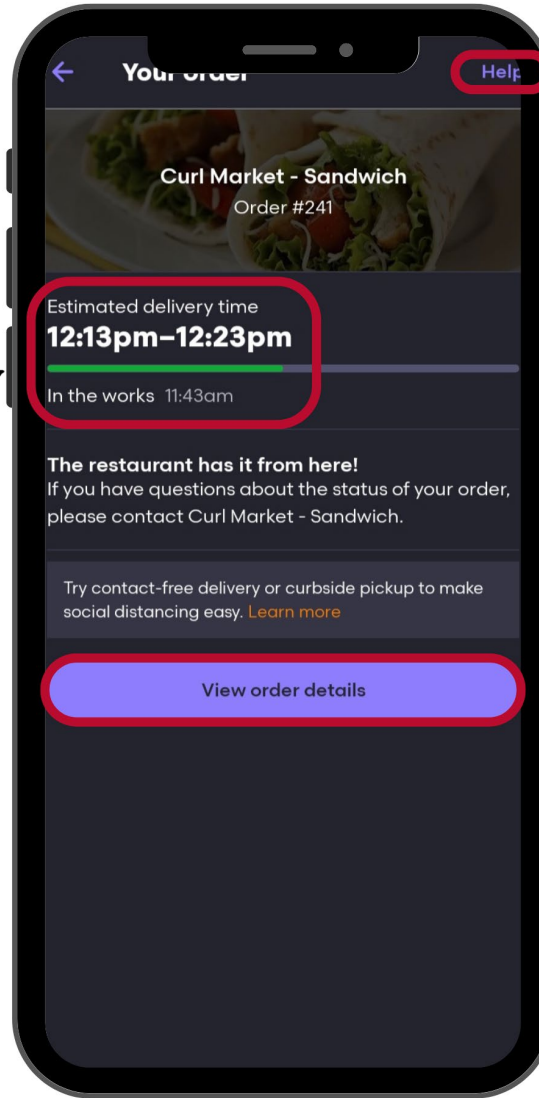
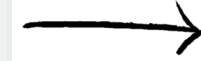

Contact Grubhub  
customer support

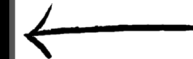

View order details



# Track robot

Track your robot once your delivery is on its way. You can follow in real-time using the map.

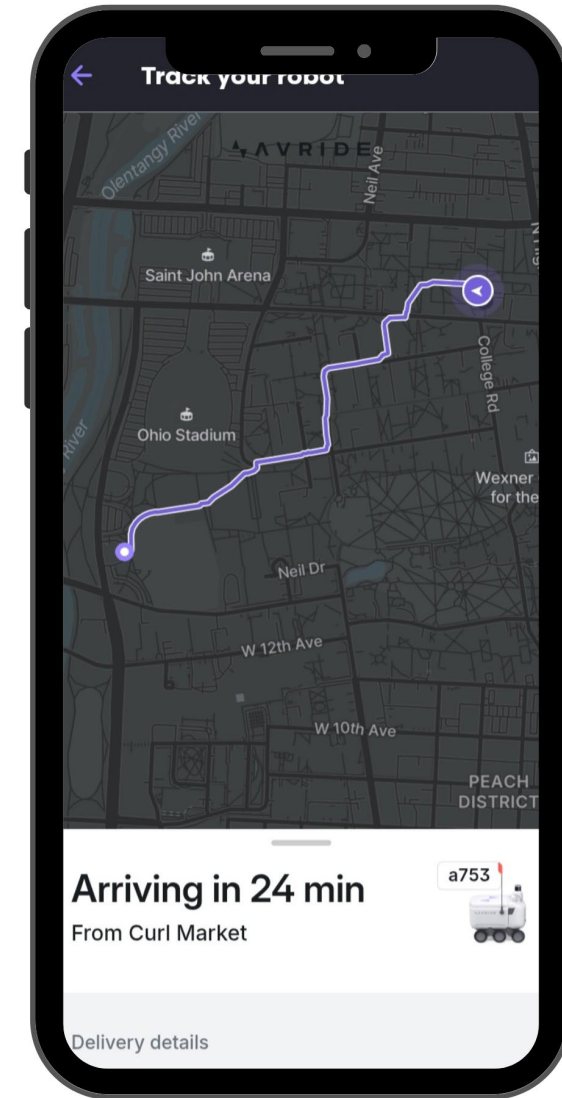

# Open robot

Once your order has arrived at your location, open the robot from your phone

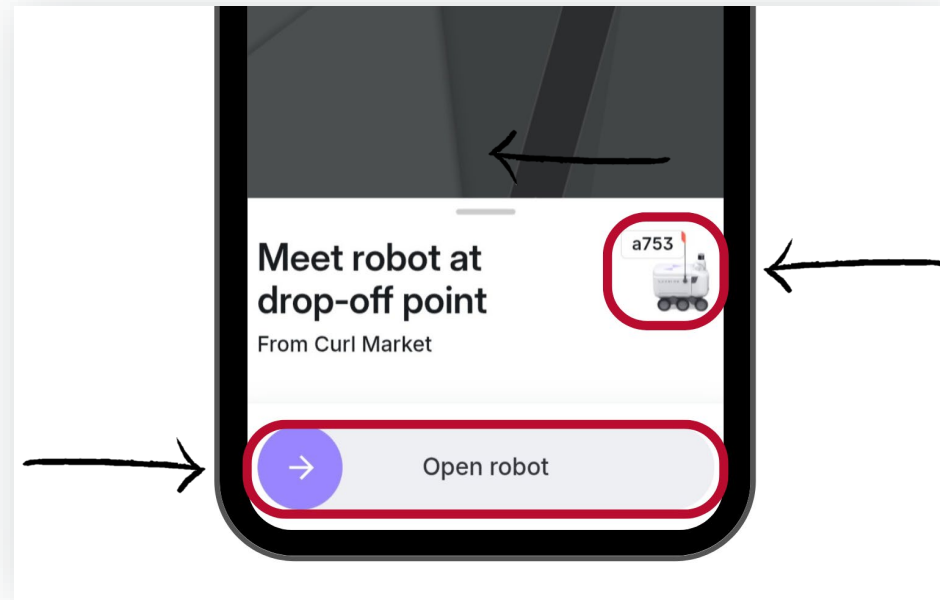

Robot number:  
This should match the ID number on the robot

Confirm that you have picked up the order or request more time

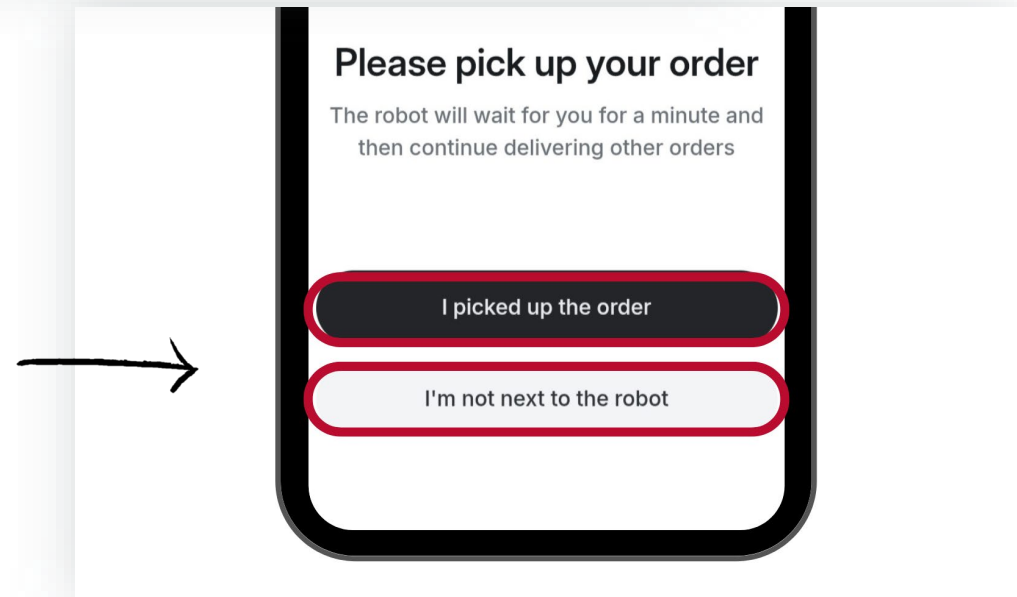

# **Grubhub Help Customer Service**



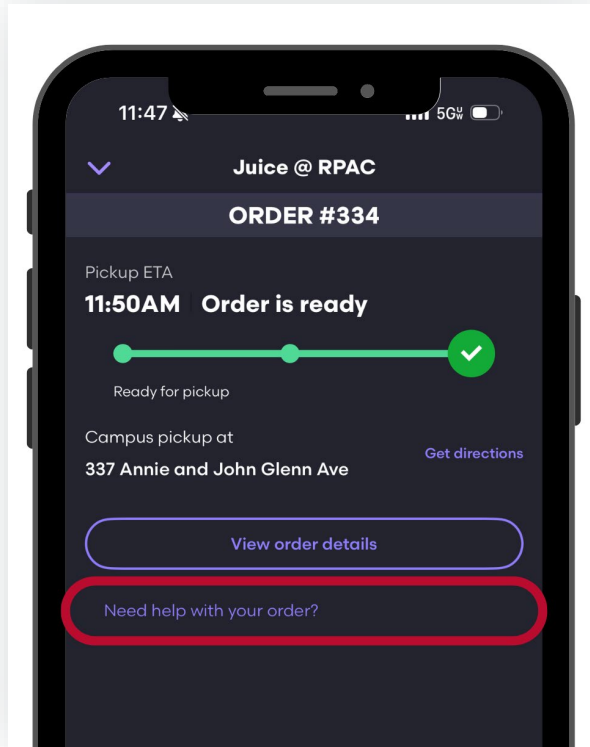

Select an order and  
tap “Need help with  
your order”

Tap “Report order issue”

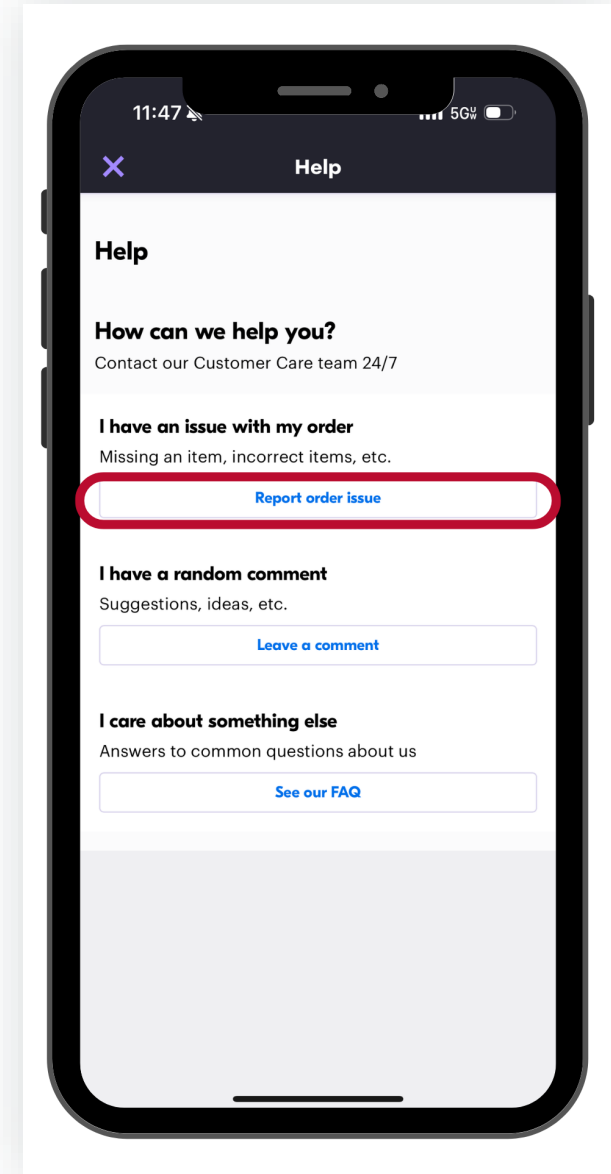

# Grubhub Help

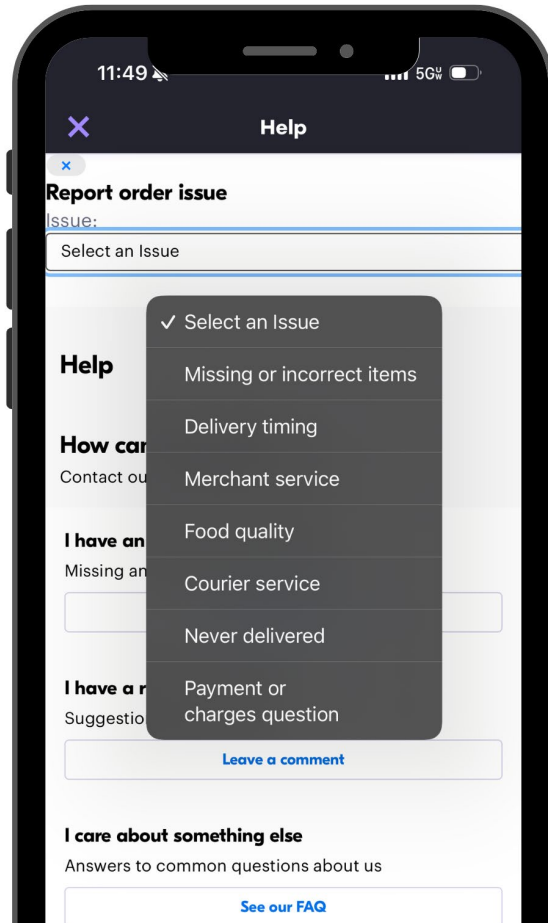

Follow the prompts  
to describe the issue

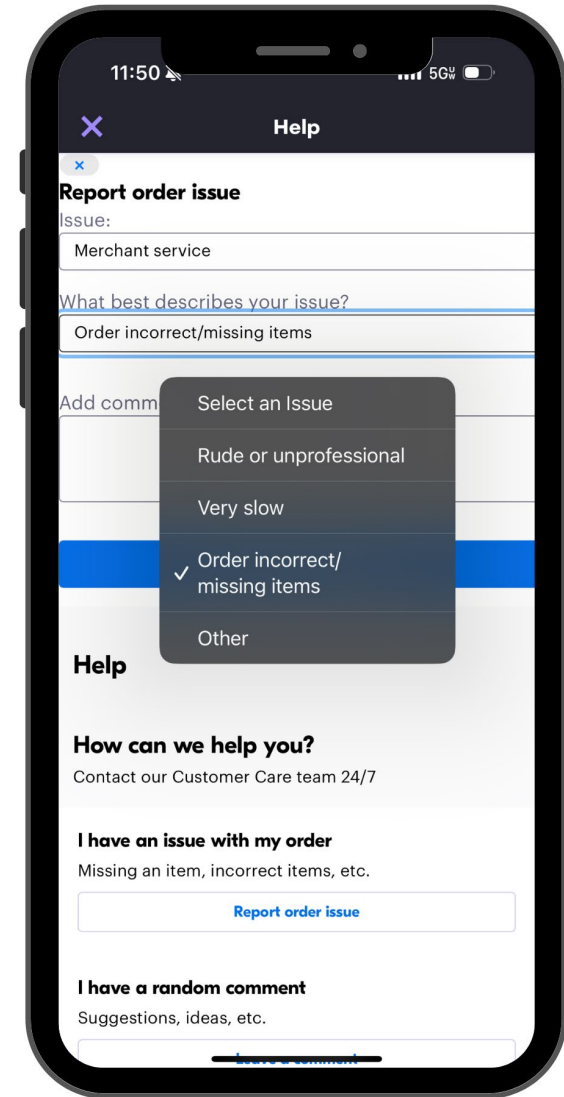

# Contact Grubhub Help



THE OHIO STATE UNIVERSITY