

# Using Grubhub Campus The Ohio State University

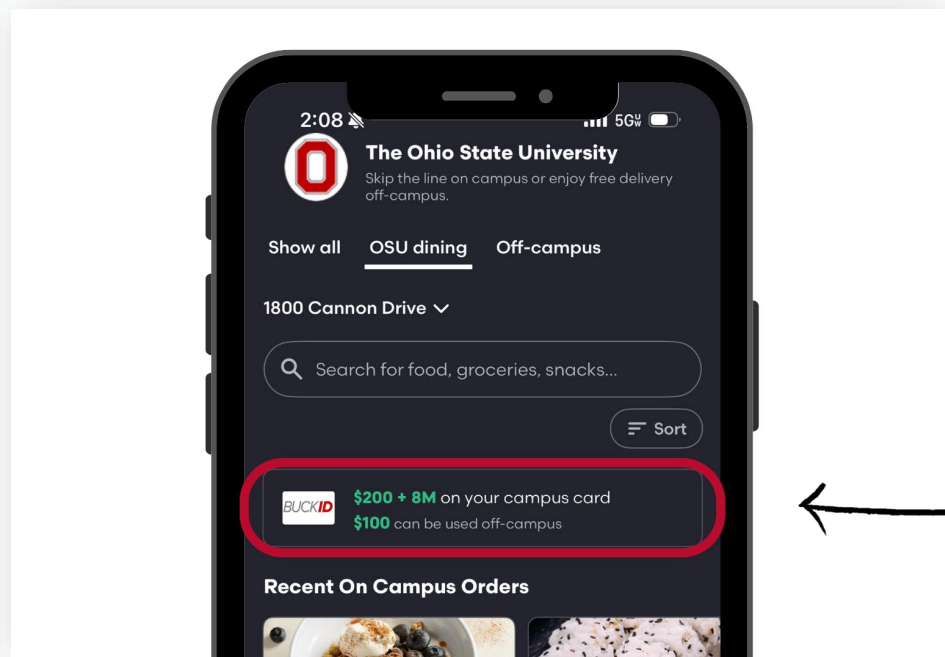

# View Your Campus Card Balance



View Campus  
Card Balance

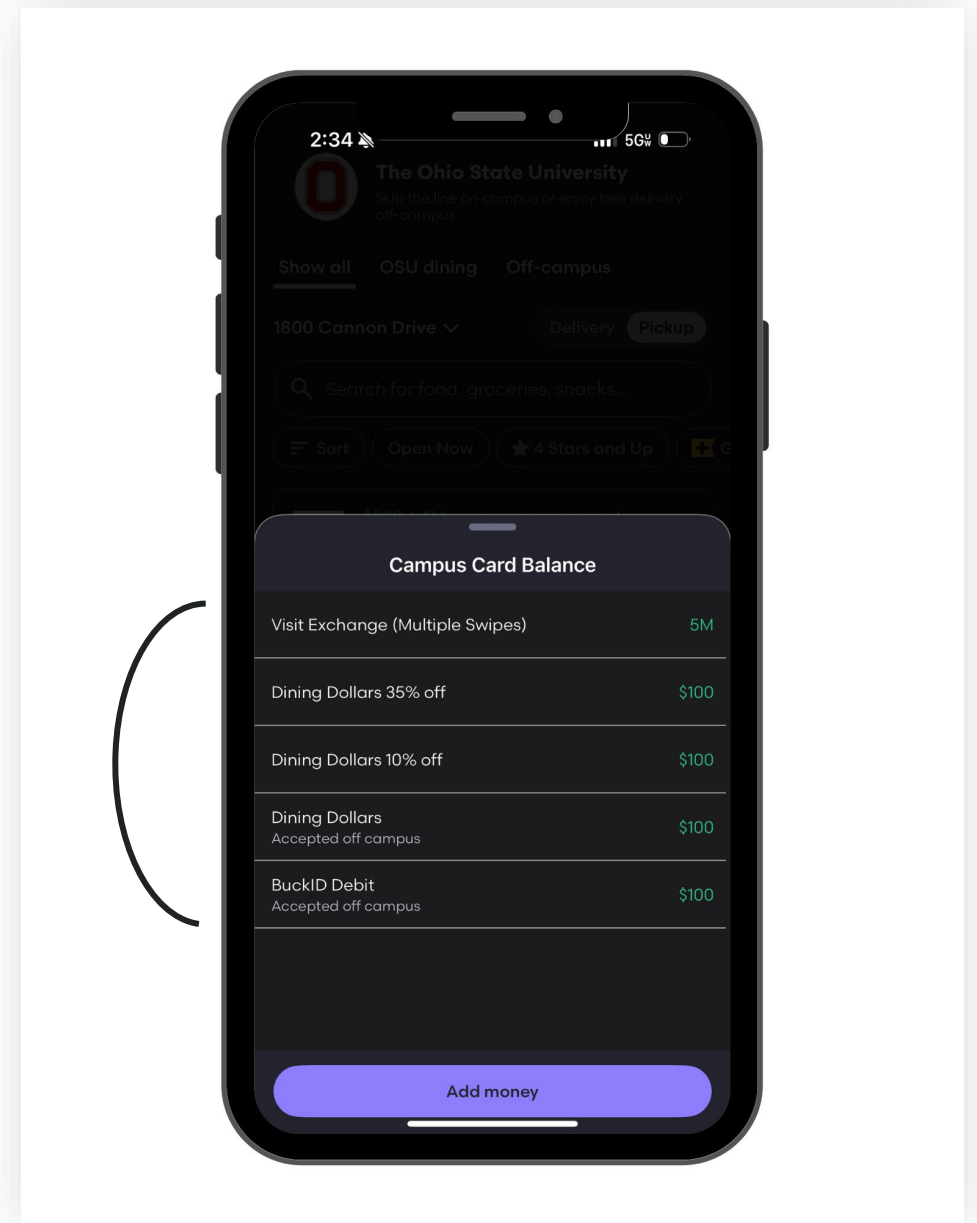
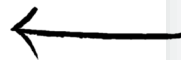

# Deposit Dining Dollars or BuckID Cash

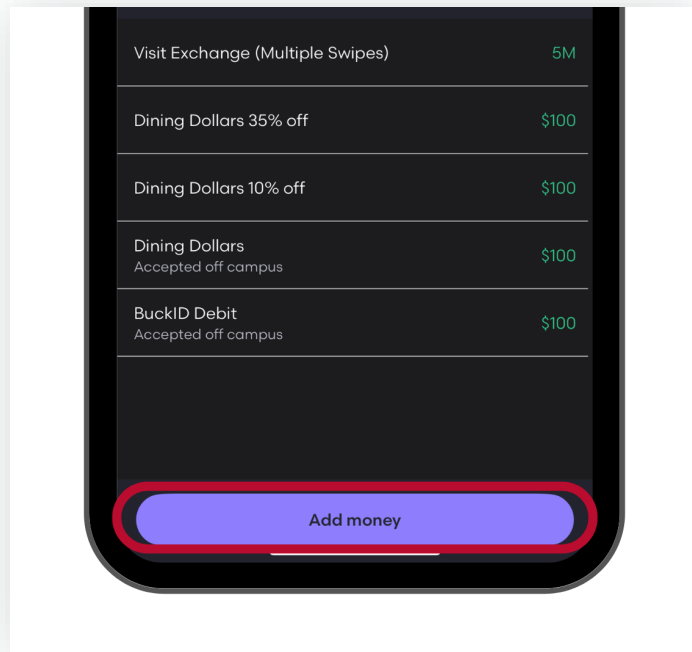

Make a Deposit to Dining Dollars or BuckID Cash by tapping “Add money” or navigating to [buckid.osu.edu](https://buckid.osu.edu)

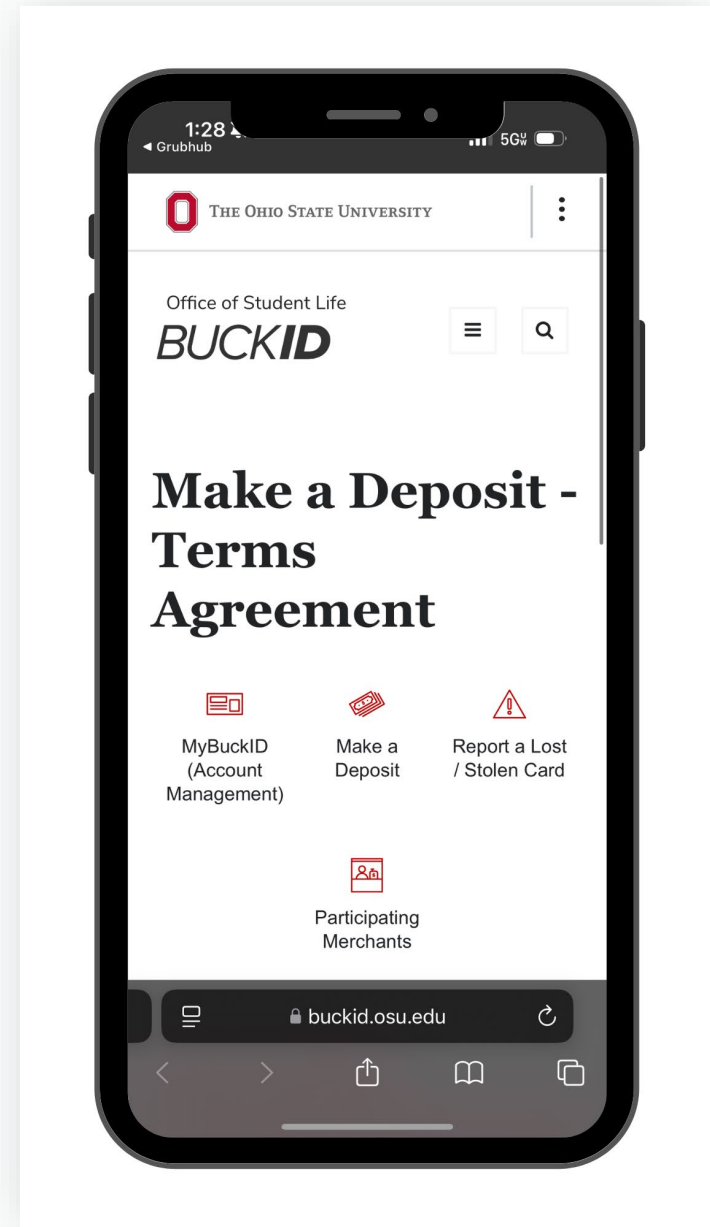

# Gray 10 and Scarlet 14: Campus Card Balance

Available **Visits/Visit Exchanges**. Can be used at Traditions, Dining Services Retail Locations (\$8 Exchange Value), or C-Stores (\$5 Exchange Value)

**BuckID Cash Balance**  
Can be added at any time, with or without a dining plan

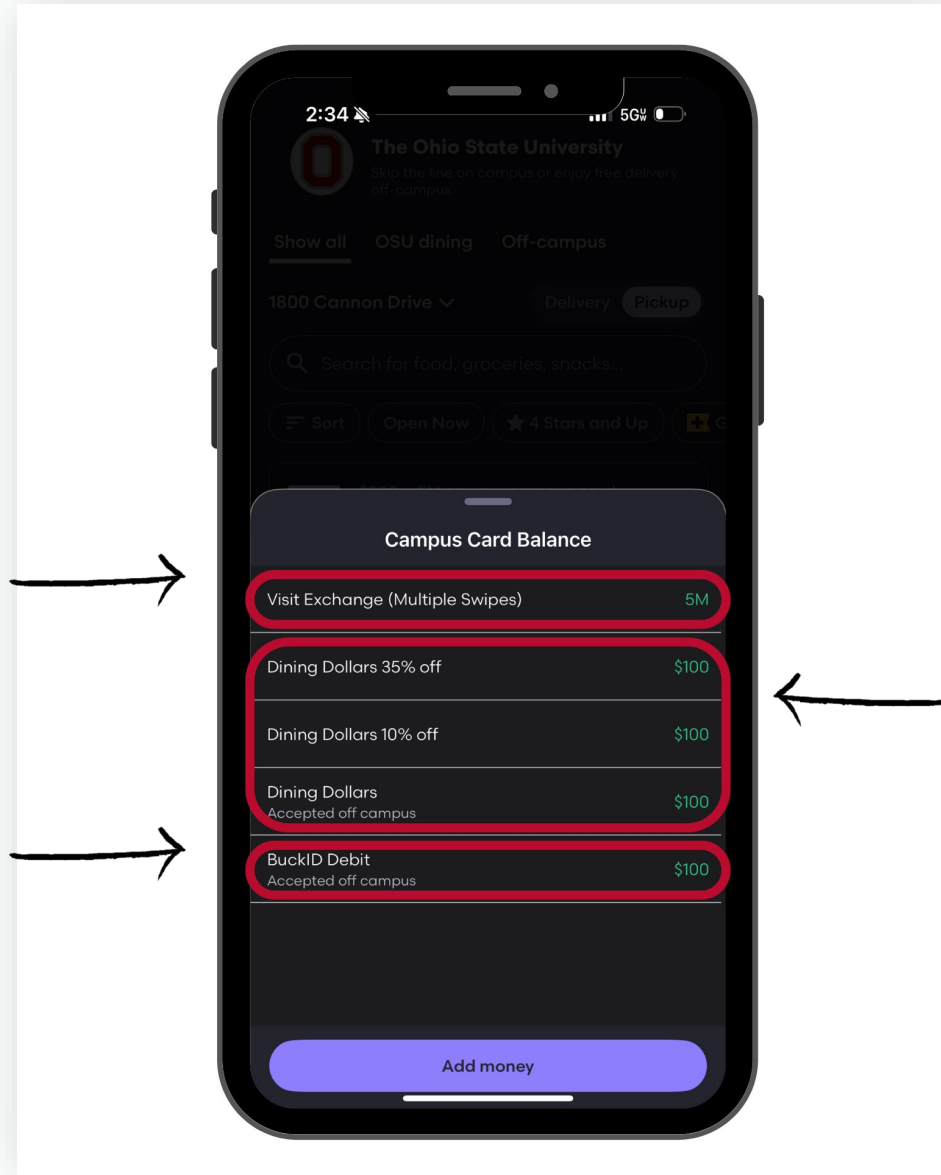

**Dining Dollars** are listed as separate lines, one for each discount rate (35% off at Dining Services Retail & Traditions Locations, 10% off at C-Stores, or at off campus locations without a discount). The dollar amount listed on all three lines refers to the same funds. In other words, for this example, the student has \$100 in **Dining Dollars** available to use.

Additional Dining Dollars can be added to any active meal plan.

# Gray 10 and Scarlet 14: Visit Exchange

Example:

In this example, the total of the order is \$10.70

Juice 2 is a “Retail” style location, so the value  
of a **Visit Exchange** is \$8

This student could use two of their **Visit  
Exchanges** to purchase this order

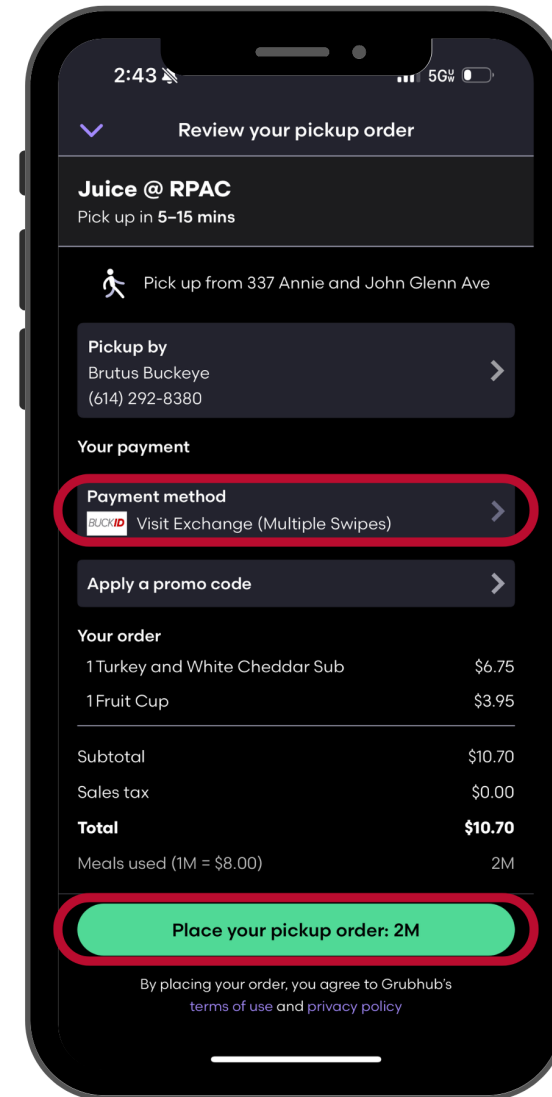

# Gray 10 and Scarlet 14: Dining Dollars or BuckID

Using the previous  
order as an example,  
the student could  
also pay with \$6.95  
Dining Dollars or  
\$10.70 BuckID Cash

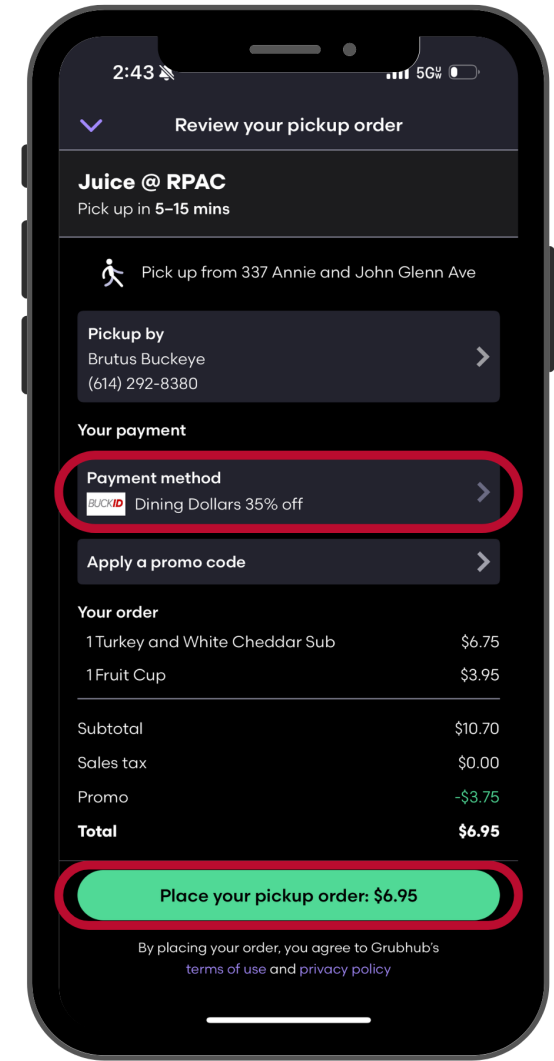
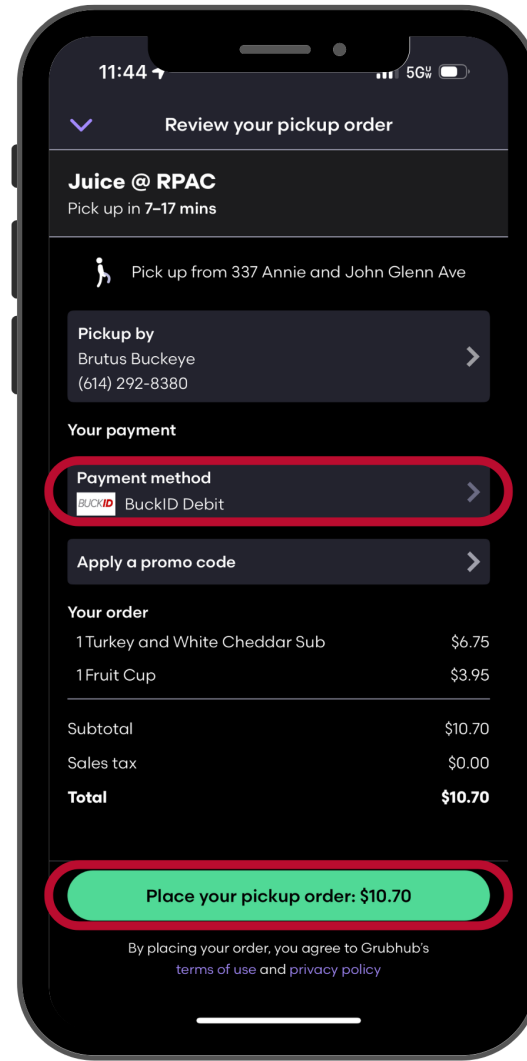

# Gray 10 and Scarlet 14: Visit + Dollars

Visit Exchanges can  
be combined with  
Dining Dollars or  
BuckID Cash

The student could  
pay with one **Visit  
Exchange** and \$2.70  
in **BuckID Cash** OR  
one **Visit Exchange**  
and \$1.75 in **Dining  
Dollars**

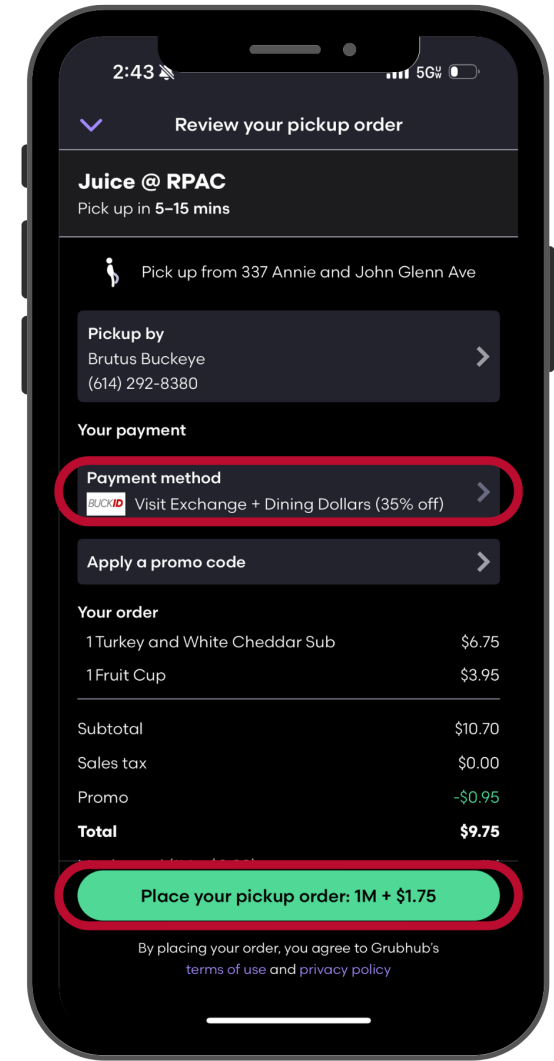
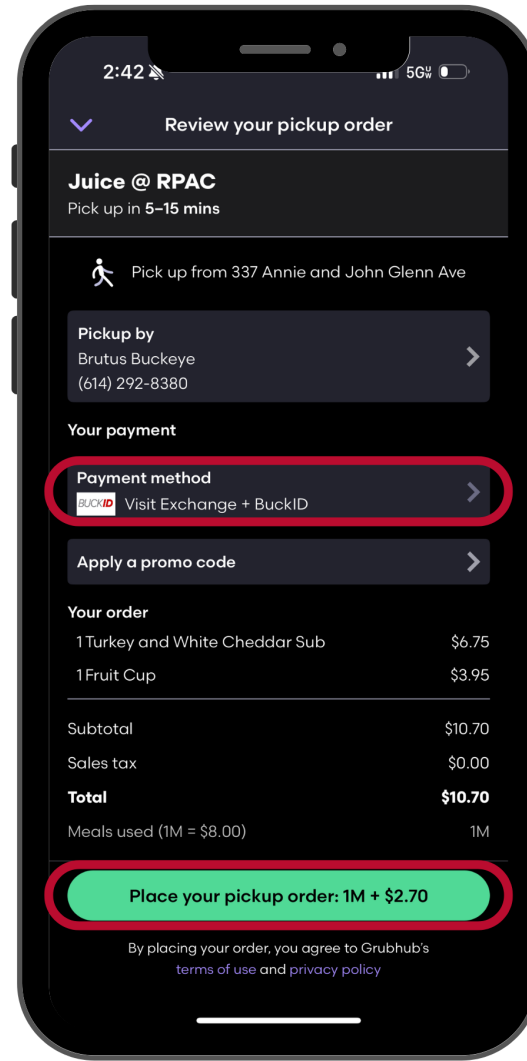

# Traditions

Unlimited **Visits** to Traditions locations, up to once per hour.

Take Traditions meals **To-Go** up to five times per week.

**Visit Exchanges** not included

**BuckID Cash Balance**  
*No funds included with this plan, but can be added at any time, with or without a dining plan*

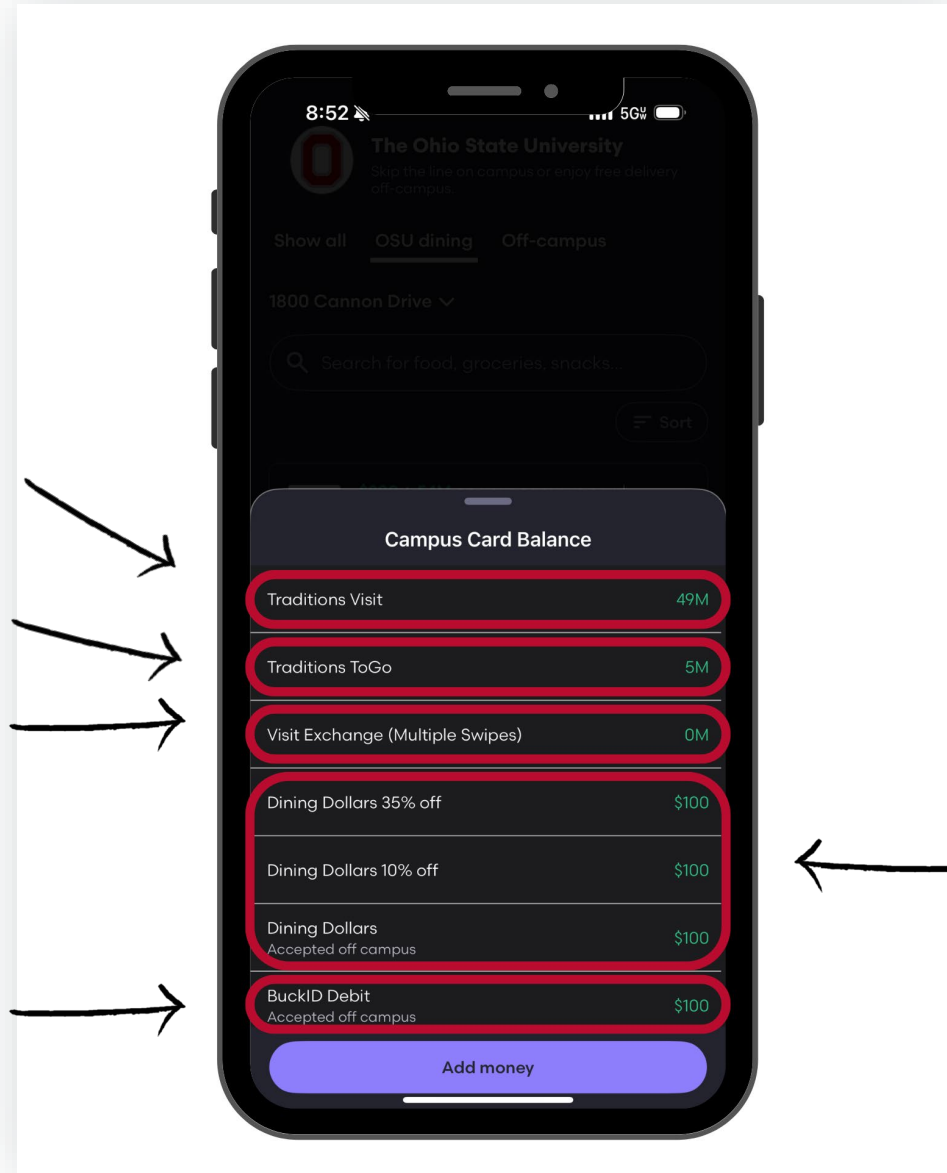

**Dining Dollars** are listed as separate lines, one for each discount rate (35% off at Dining Services Retail & Traditions Locations, 10% off at C-Stores, or at off campus locations without a discount). The dollar amount listed on all three lines refers to the same funds. In other words, for this example, the student has \$100 in **Dining Dollars** available to use.

Additional **Dining Dollars** can be added to any active meal plan.





# Traditions: Visit

Example:

Students on the Traditions Dining Plan can access Traditions locations once every hour, unlimited times per week by using a **Traditions Visit**

*In this example, the student can order the entrée made-to-order because Traditions at Morrill is a to-go only location*

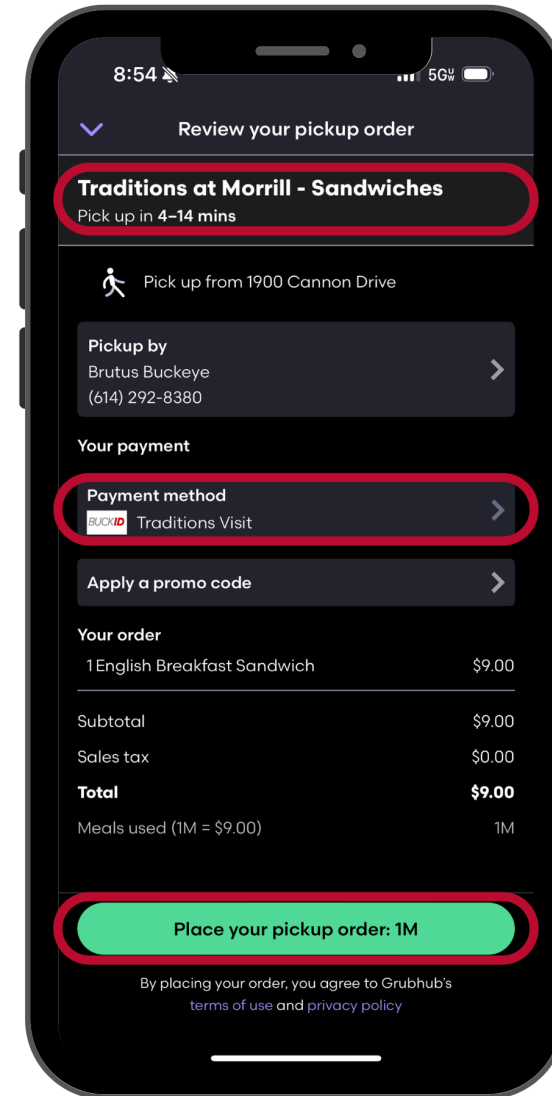

# Traditions: To-Go Visit

Example:

Students on the Traditions Dining Plan can order food to-go up to five times per week from a Traditions location by using a **Traditions To-Go Visit**

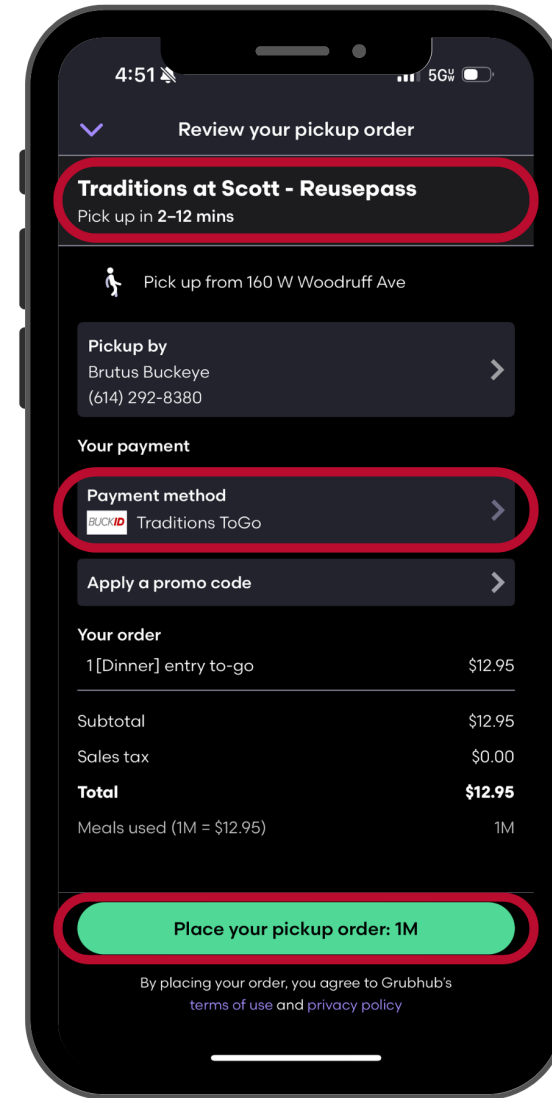

# Traditions: Dining Dollars or BuckID

Using the previous  
order as an example,  
the student could  
also pay with \$6.95  
**Dining Dollars** or  
\$10.70 **BuckID**  
Cash

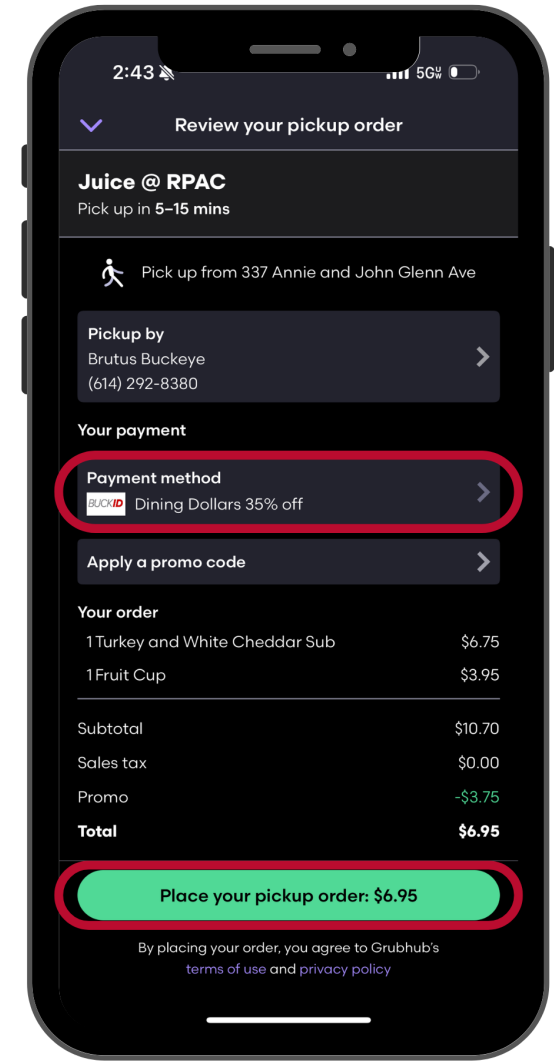
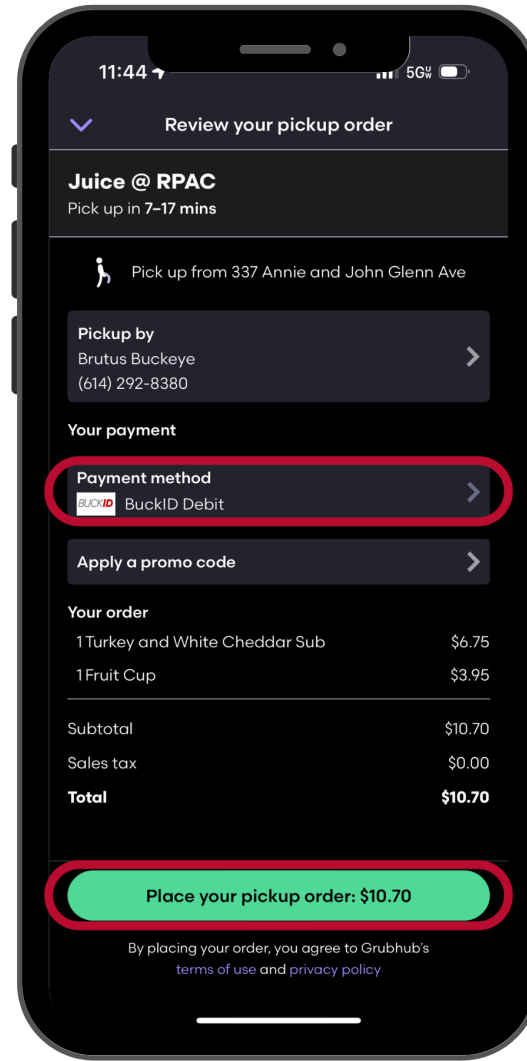

# Traditions Plus: Exchange

Includes all **Payment Methods** included with the Traditions Dining Plan.

In Grubhub, **Traditions To-Go** is replaced by “**Visit Exchanges**”

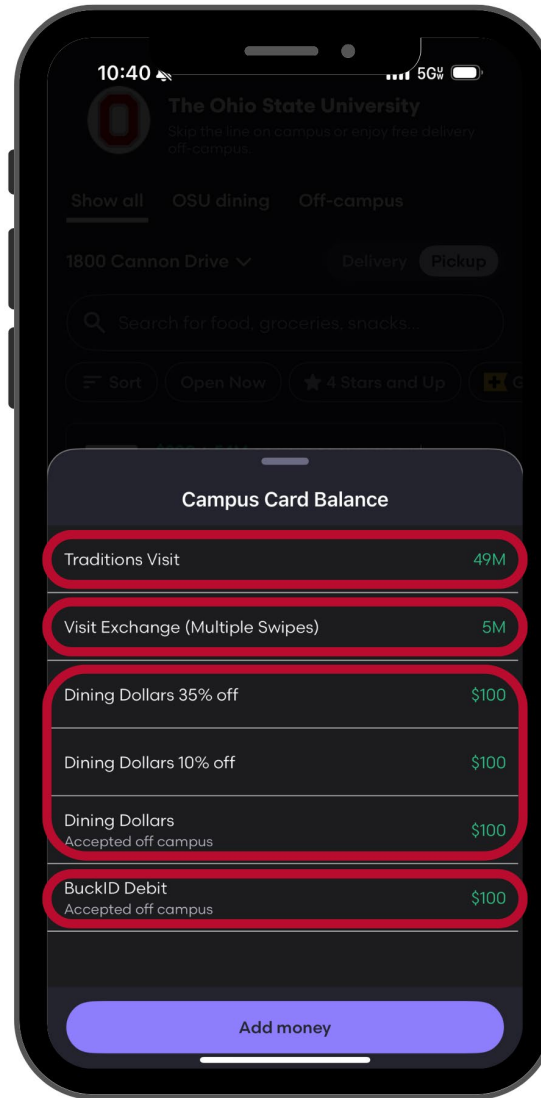
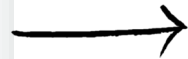

The Traditions Plus Add On allows students to **exchange** up to 5 of their included weekly **To-Go Visits** for either an \$8 exchange at a retail location or a \$5 exchange at a C-Store.



# Traditions Plus

Example:

Students on the Traditions Plus Dining Plan can access Traditions locations once every hour, unlimited times per week by using a **Traditions Visit**

*In this example, the student can order the entrée made-to-order because Traditions at Morrill is a to-go only location*

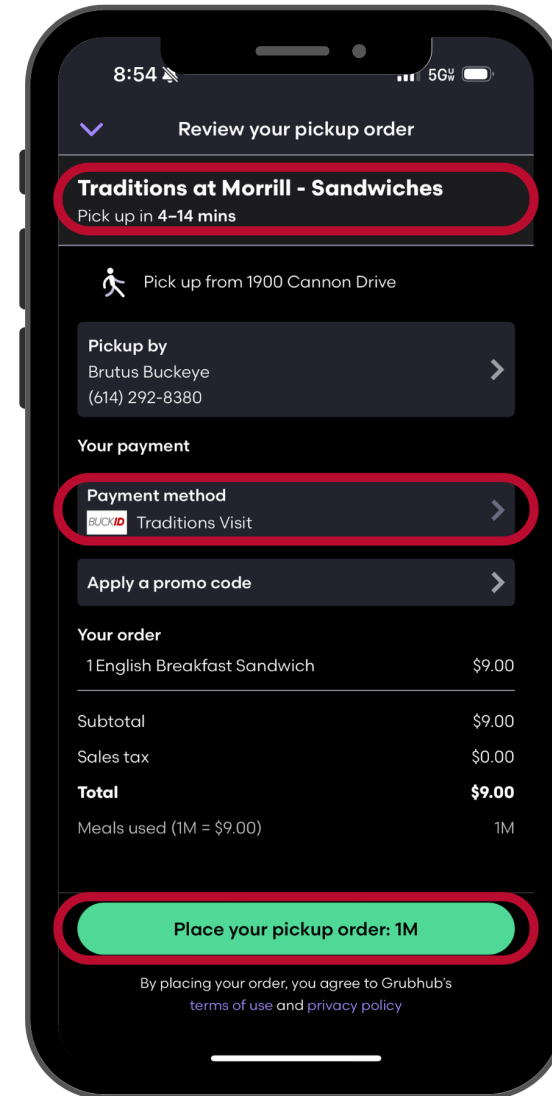

# Traditions Plus: Visit Exchange

Example:

Students on the Traditions Plus Dining Plan can order food to-go up to 5 times per week from a Traditions location, by using a **Visit Exchange**

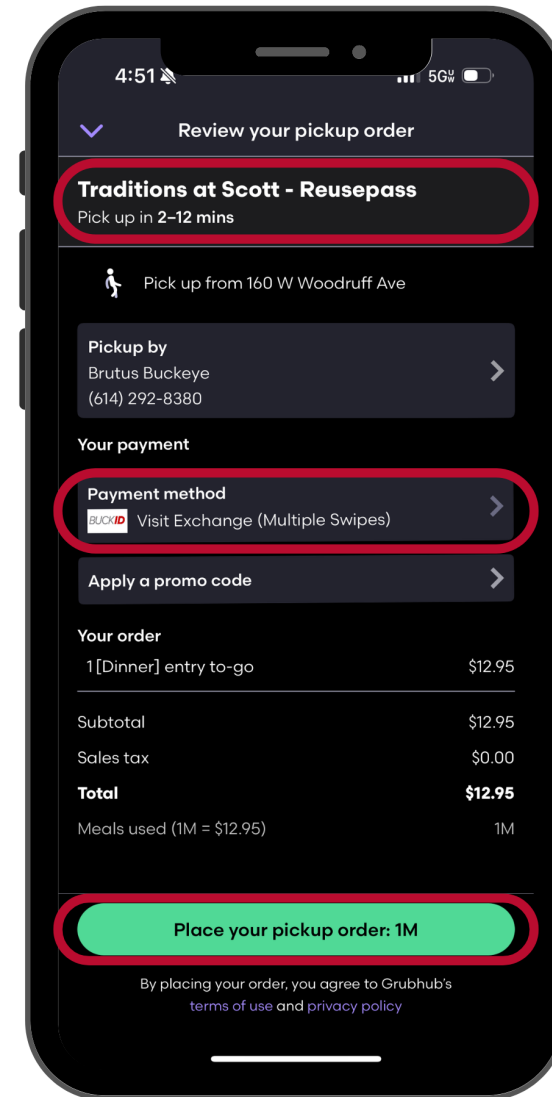

# Traditions Plus: To-Go Visit

## Exchanging a Traditions To-Go Visit

In this example, the total of the order is \$10.70

Juice 2 is a “Retail” style location, so the value of a **Visit Exchange** is \$8

This student could use two of their **Visit Exchanges** to purchase this order

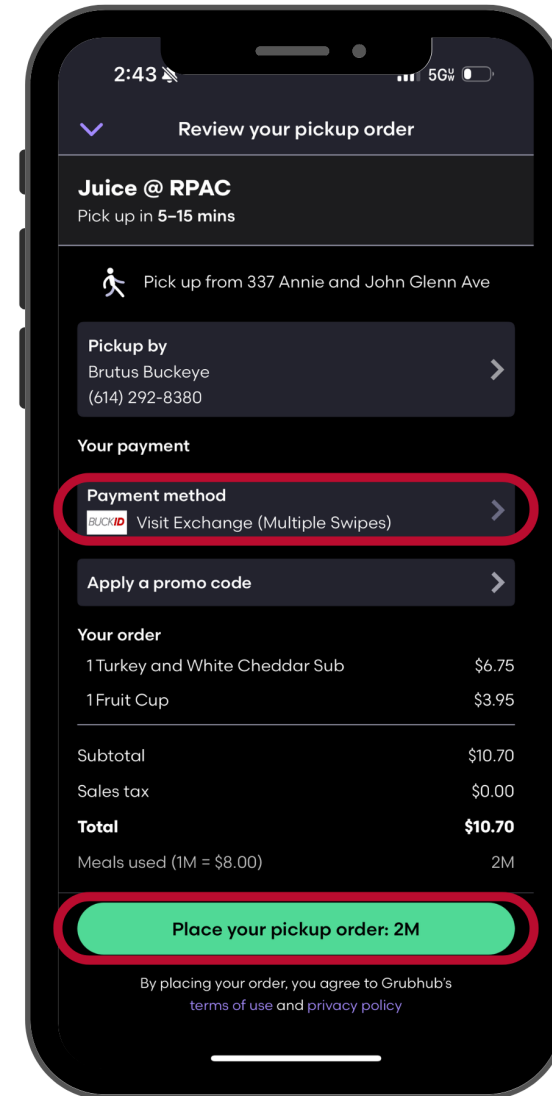

# Traditions Plus: Dollars

Using the previous order as an example, the student could also pay with \$6.95 Dining Dollars or \$10.70 BuckID Cash

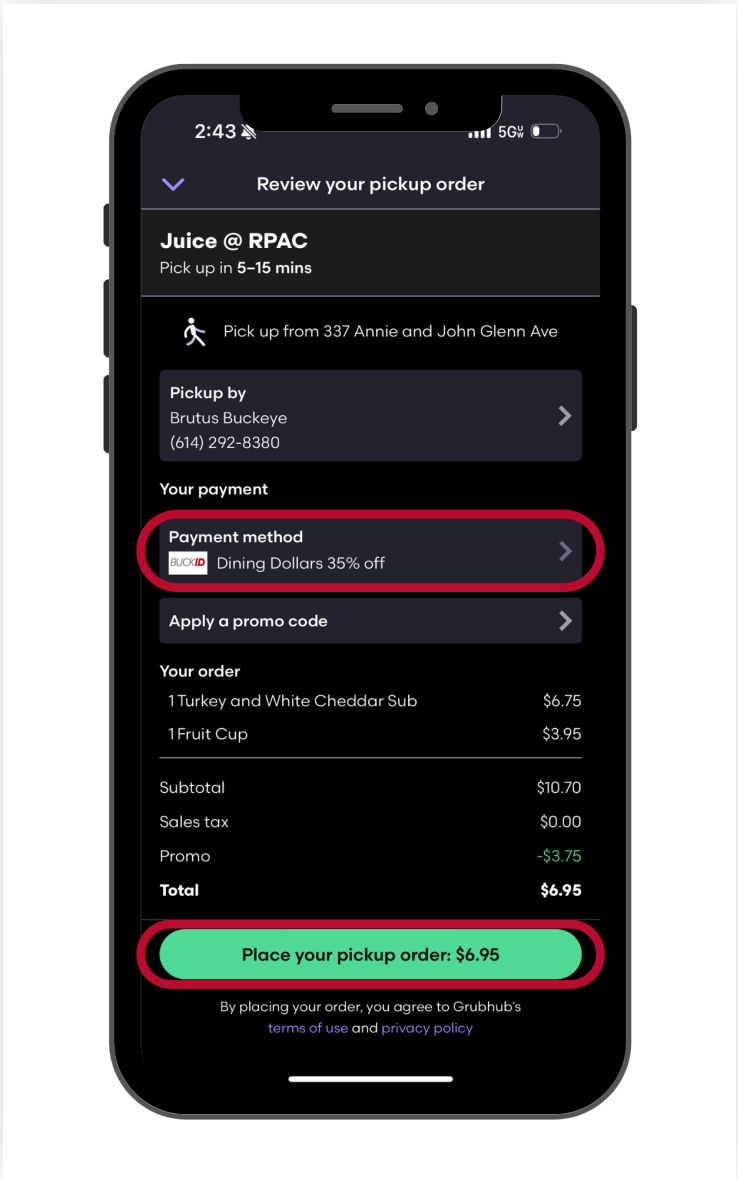
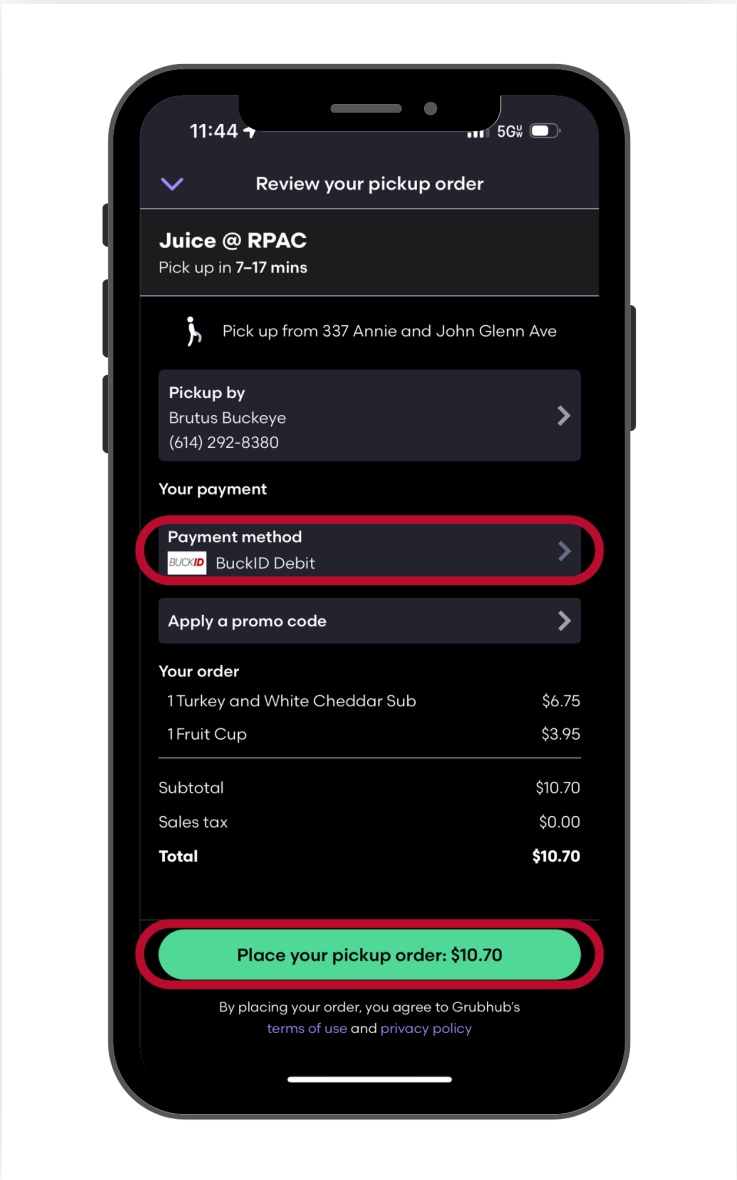



# Traditions Plus: Visit + Dollars

Visit Exchanges can  
be combined with  
Dining Dollars or  
BuckID Cash

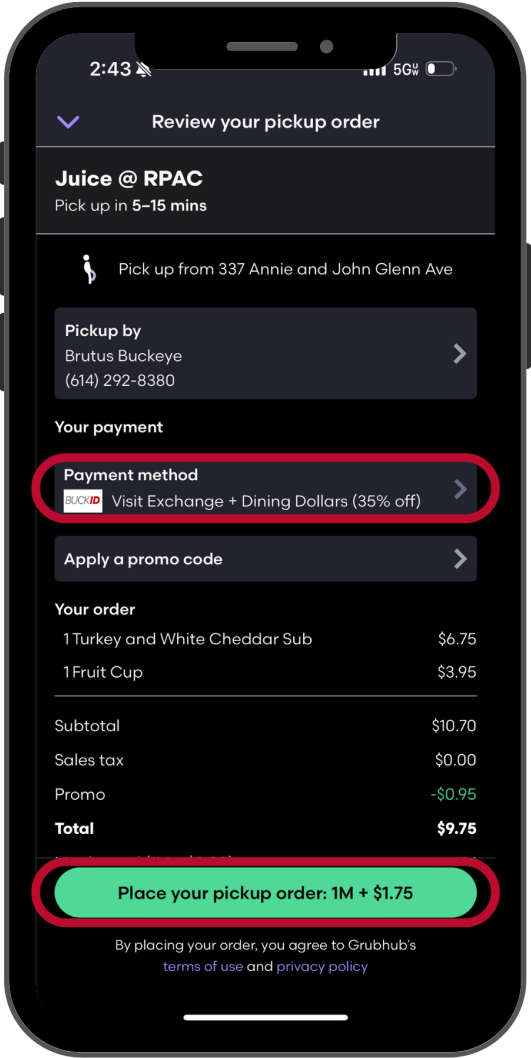
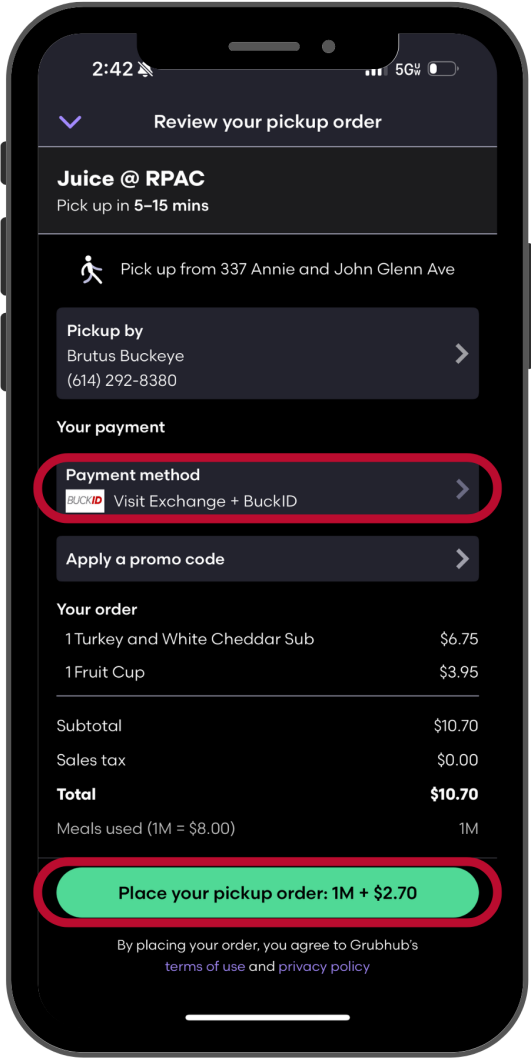

# Declining Balance, Carmen 1 and Carmen 2

Visits and Visit Exchanges are not included – Students can use **Dining Dollars** and **BuckID Cash** to enter Traditions Locations or to purchase meals at other locations

**BuckID Cash Balance**  
*No funds included with these plans, but can be added at any time, with or without a dining plan*

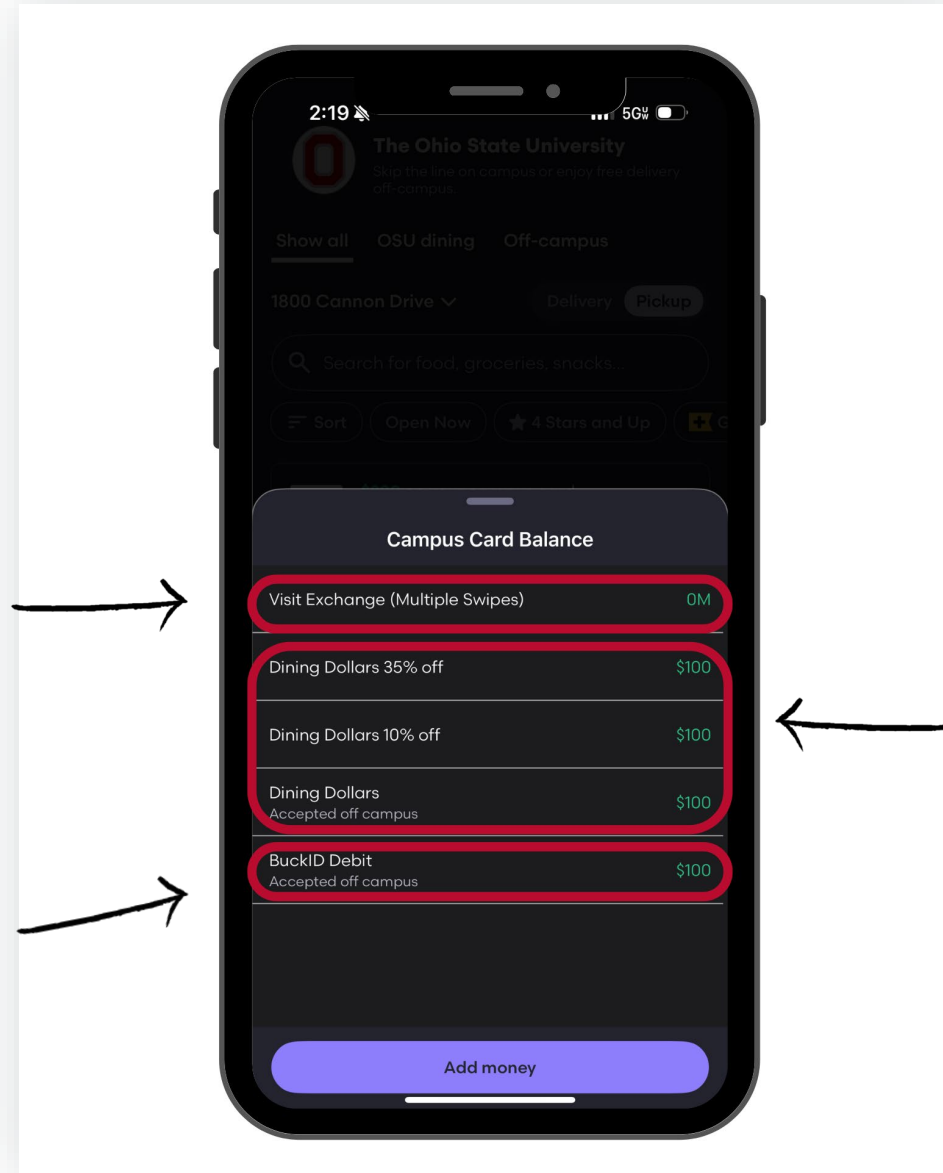

**Dining Dollars** are listed as separate lines, one for each discount rate (35% off at Dining Services Retail & Traditions Locations, 10% off at C-Stores, or at off-campus locations without a discount). The dollar amount listed on all three lines refers to the same funds. In other words, for this example, the student has \$100 in **Dining Dollars** available to use.

Additional Dining Dollars can be added to any active meal plan.



# Using Declining Balance, Carmen 1 and Carmen 2

In this example, the student could also pay with \$6.95 Dining Dollars or \$10.70 BuckID Cash

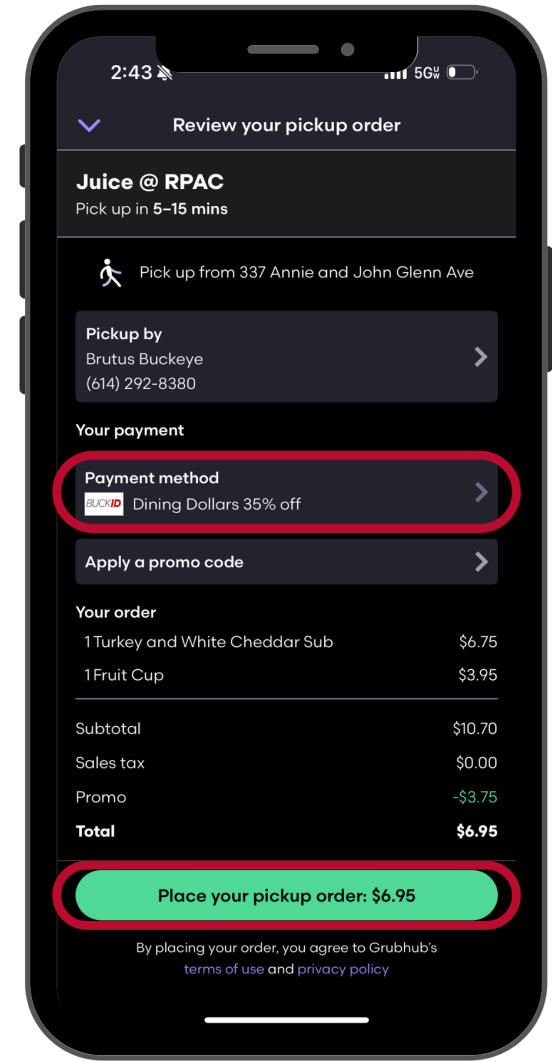
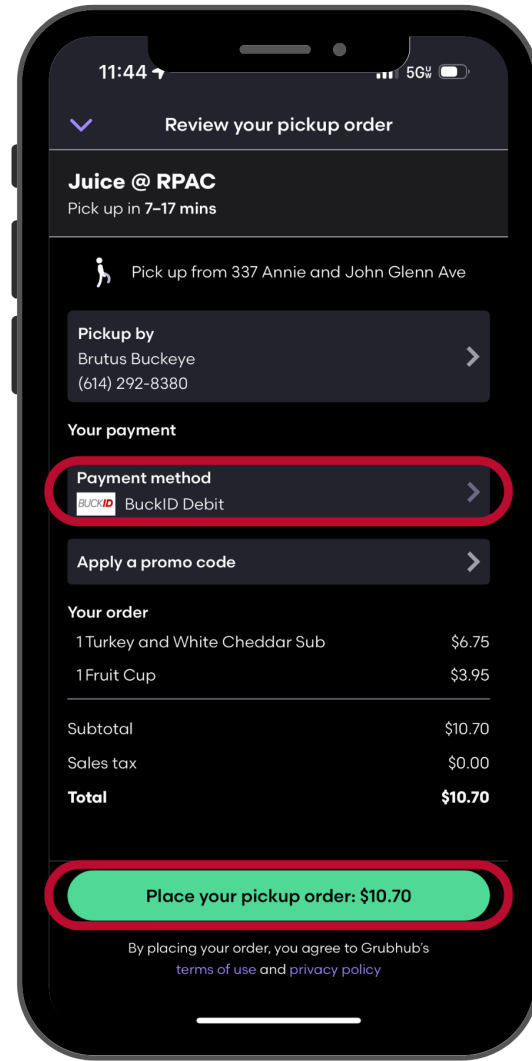

# **Grubhub Help Customer Service**



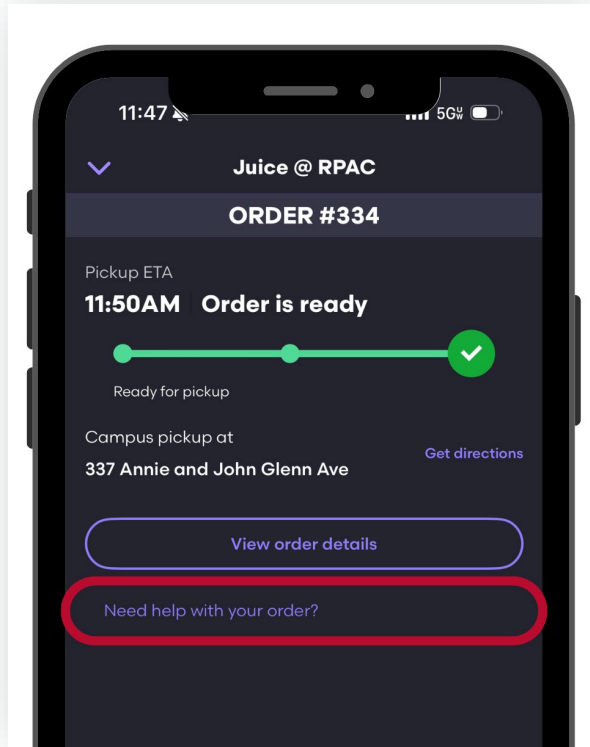

Select an order and  
tap “Need help with  
your order”

Tap “Report order issue”

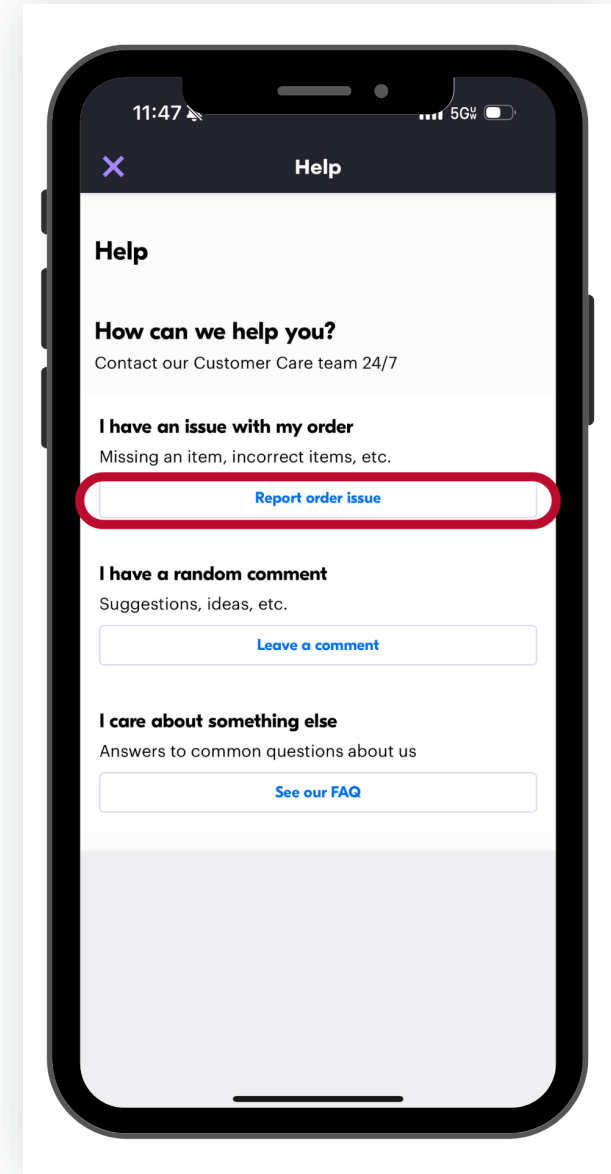

# Grubhub Help



THE OHIO STATE UNIVERSITY

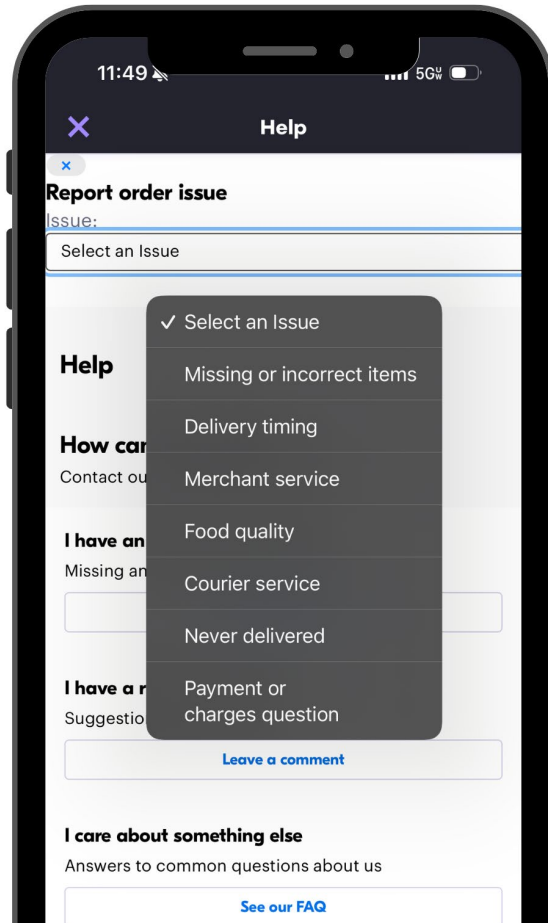

Follow the prompts  
to describe the issue

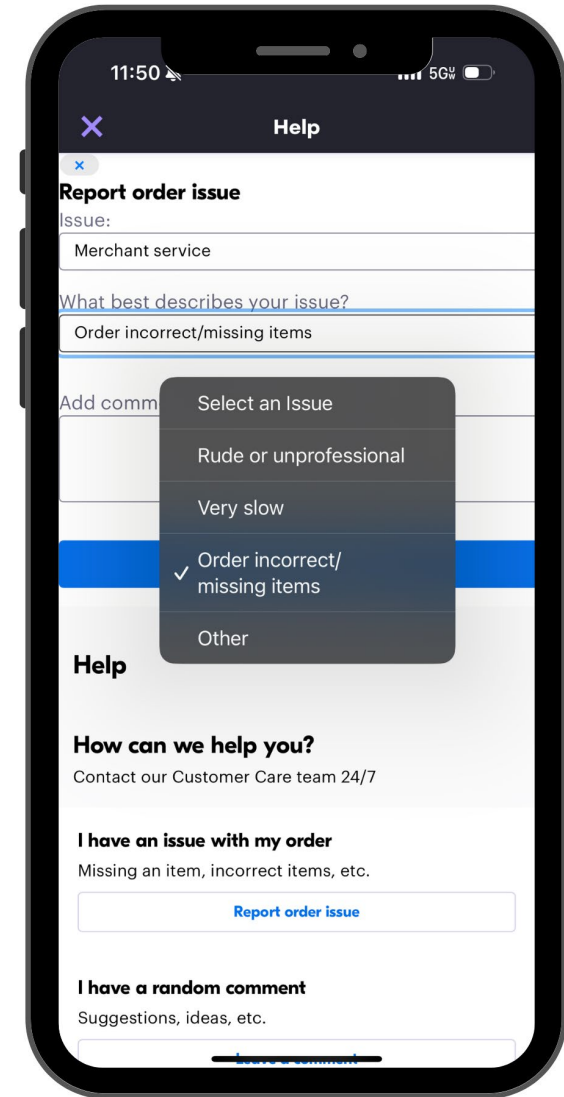

# Contact Grubhub Help



THE OHIO STATE UNIVERSITY